

INSTALLING THE EZ6 CORNER BRACKETS

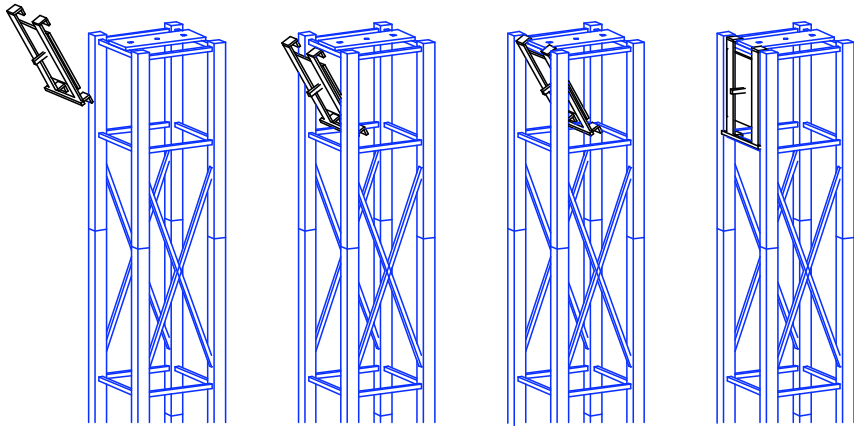

UPPER TRUSS

INSERT BRACKET INTO TRUSS VERTICAL AS SHOWN, HANG THE BRACKET OFF THE TOP WIRE WITH THE LOWER HOOKS BEHIND THE LOWER WIRE.

LOWER TRUSS

INSERT BRACKET INTO TRUSS VERTICAL AS SHOWN, HANG THE BRACKET OFF THE UPPER WIRE WITH THE LOWER HOOKS BEHIND THE BOTTOM WIRE.

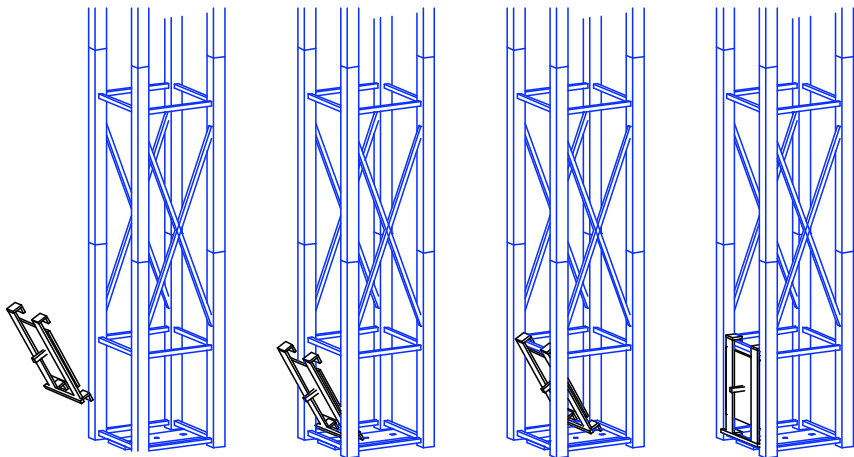

UPPER HORIZONTAL TRUSS MOUNTS FLUSH WITH TOP OF UPRIGHT

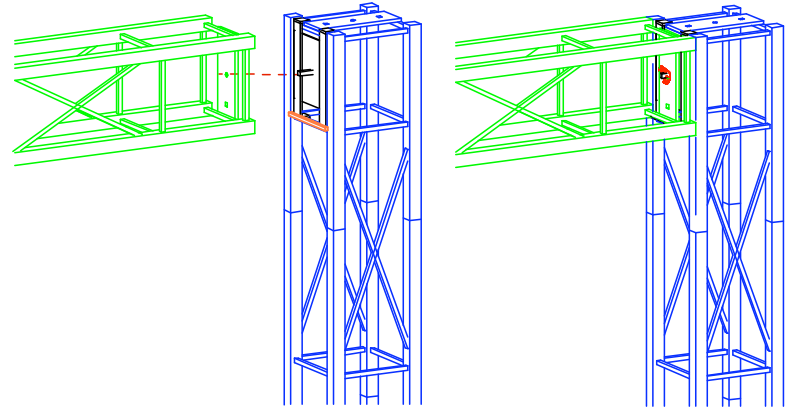

ATTACH HORIZONTAL TRUSS SO THAT THE STUD (ON THE BRACKET) PASSES THROUGH THE CENTER HOLE OF THE ENDPLATE AS SHOWN AND LOCK PARTS INTO PLACE USING THE WINGNUT AS SHOWN. ENSURE THAT THE ALIGNMENT ROD (ORANGE) ON THE BRACKET IS SEATED BETWEEN THE TRUSS CORDS

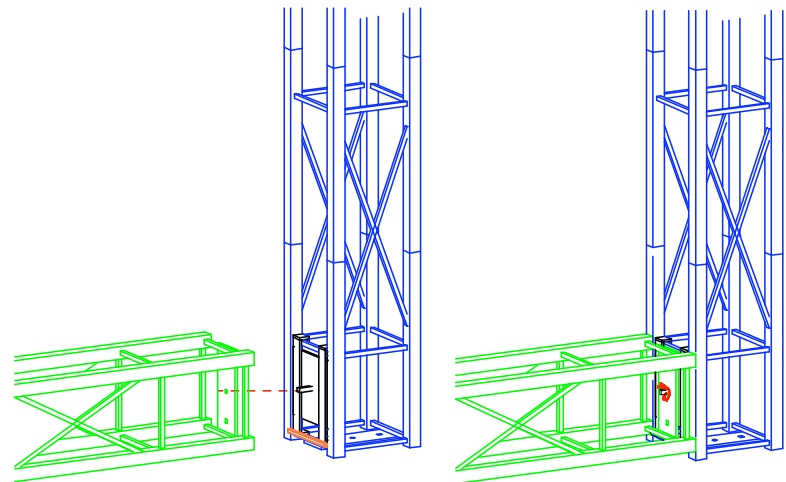

BASE HORIZONTAL TRUSS MOUNTS 1/2" OFF THE GROUND

DESIGN : EZ6 Corner Bracket Installation

REFERENCE:

The designs shown herein are the proprietary property of Trussworks and protected by copyright and other laws. This document is to be maintained in confidence. No portion of the information or design shown herein may be reproduced, electronically or otherwise, nor may any display be made from this design without written consent from Trussworks.