

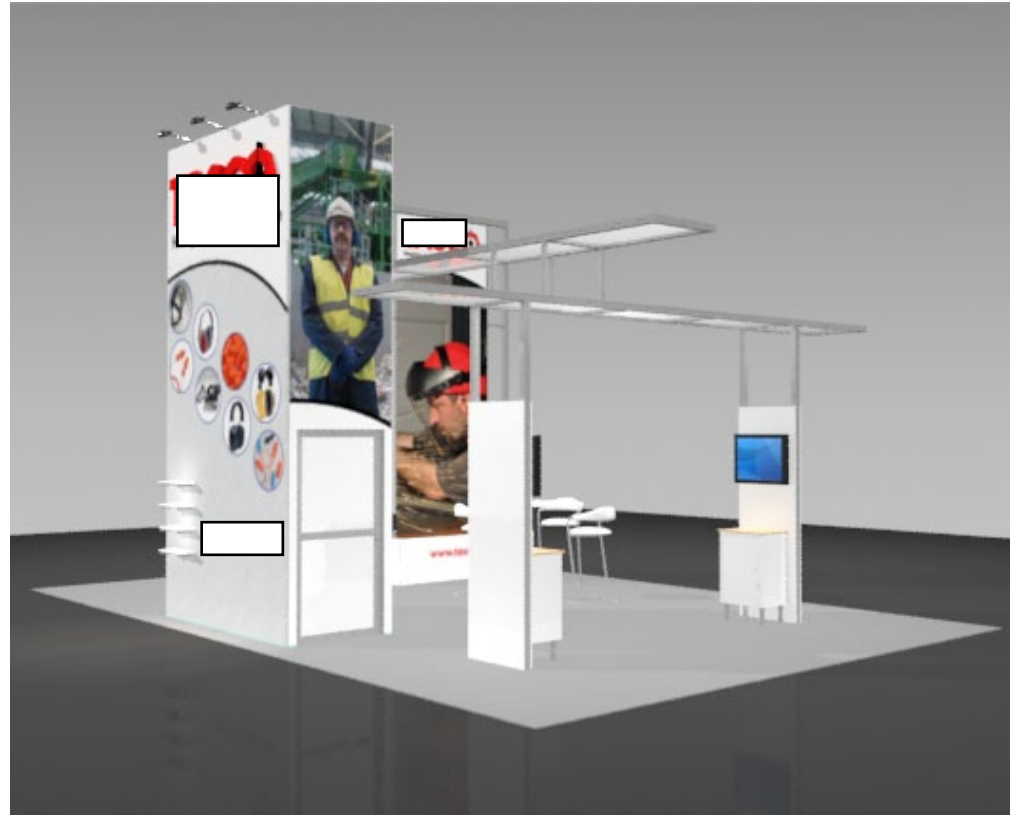

PERSPECTIVE 1

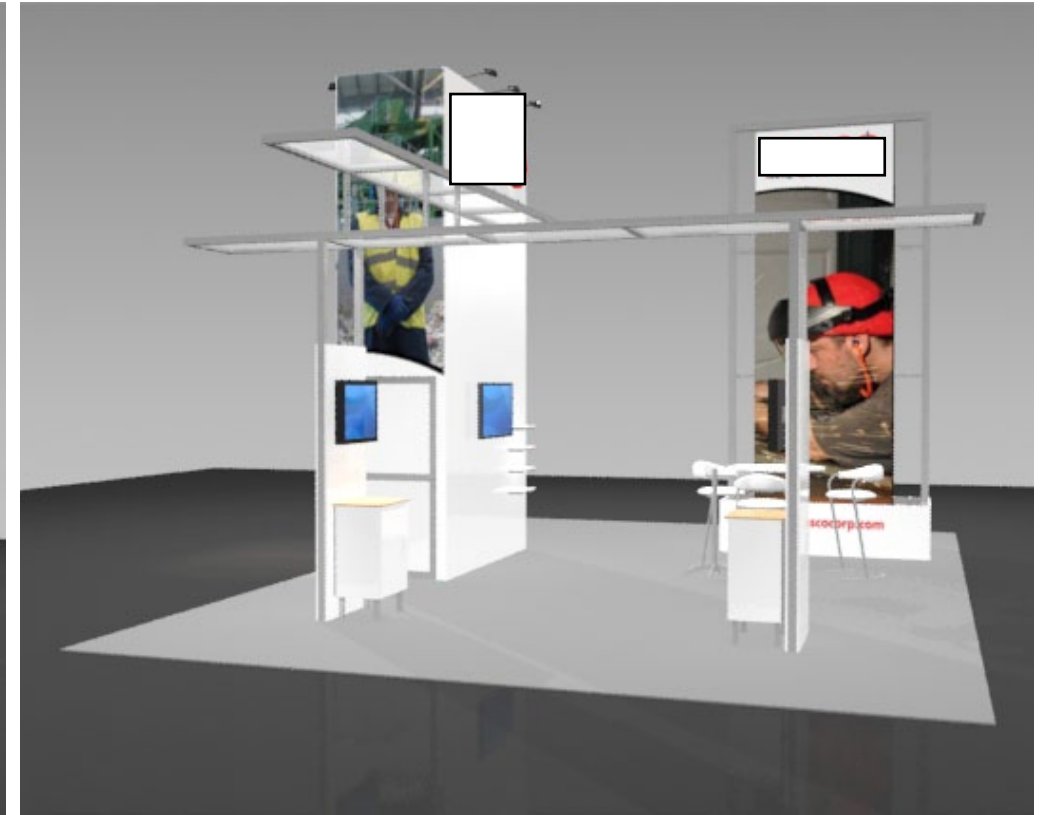

PERSPECTIVE 2



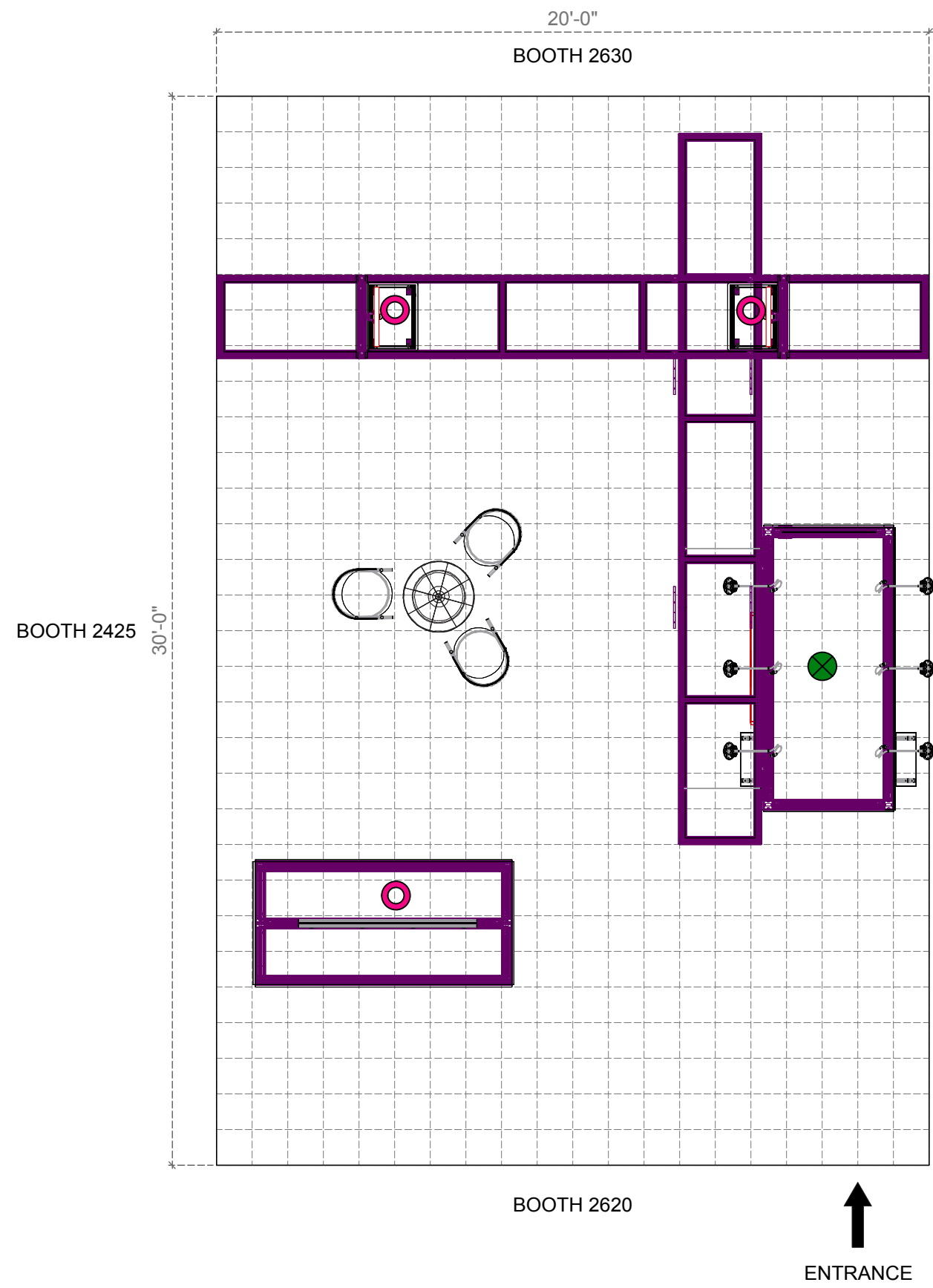

PERSPECTIVE 3

SETUP INSTRUCTION



KEYS

-  1FT X 1FT
-  (1) X 1,000W
-  (3) X 500W

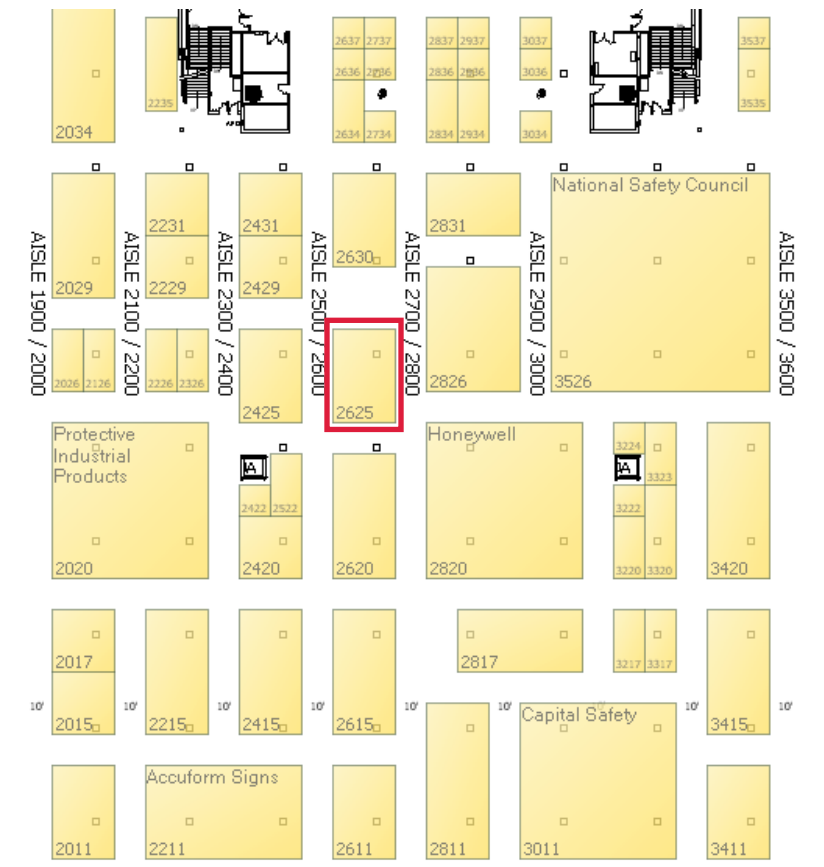

ELECTRICAL PLAN

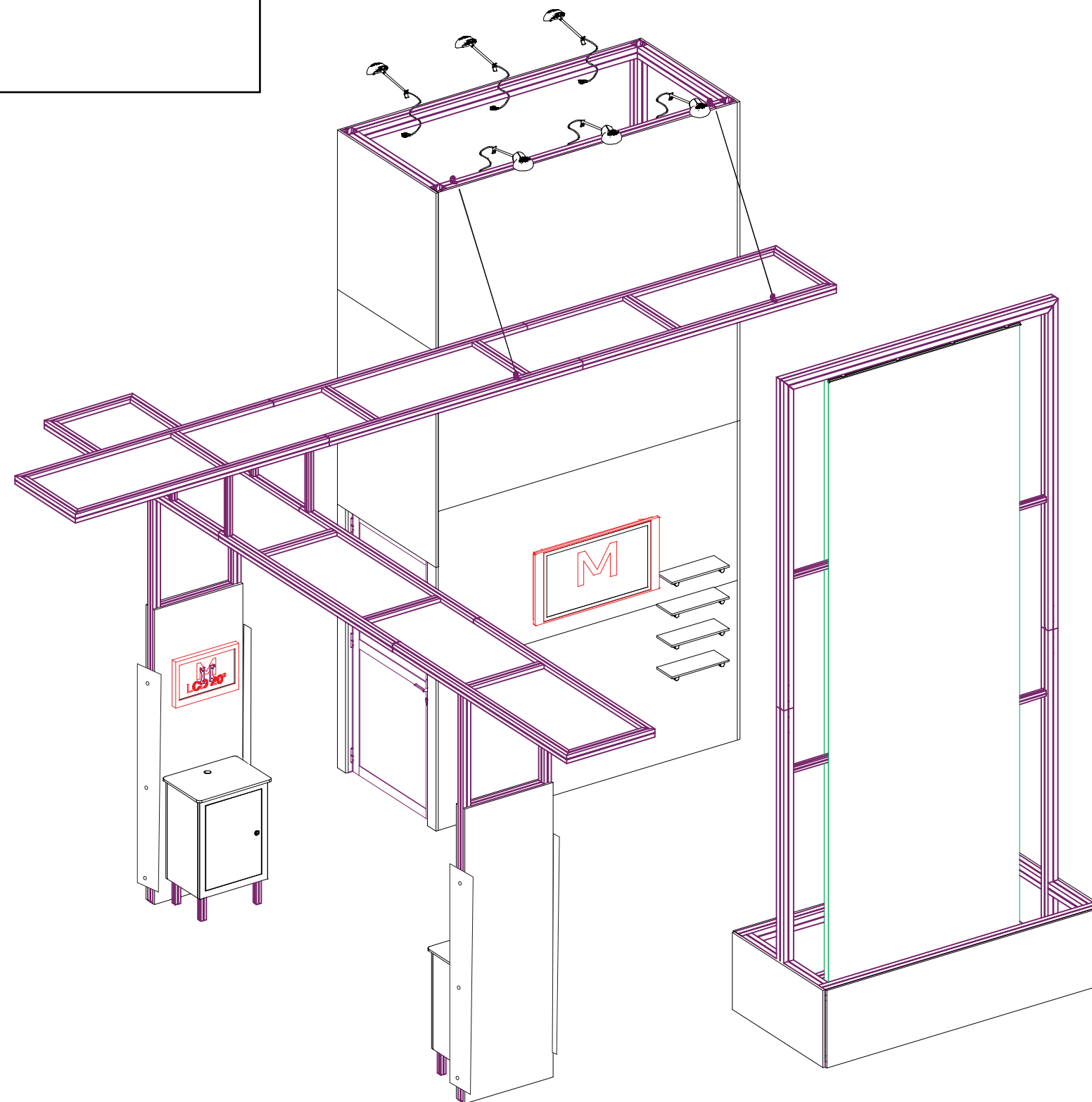
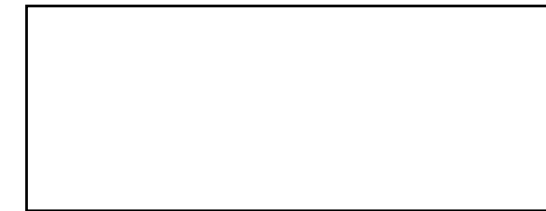
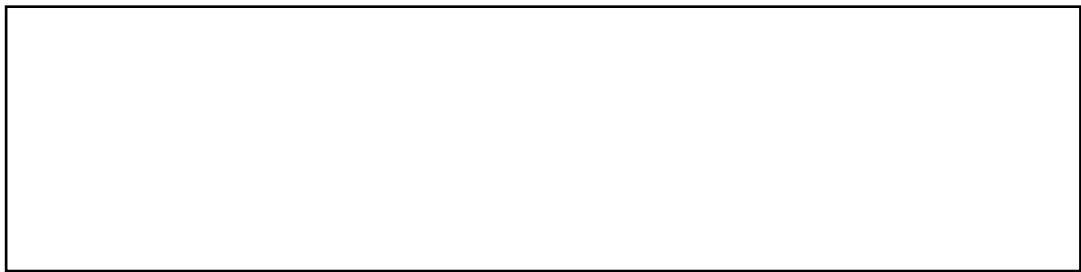

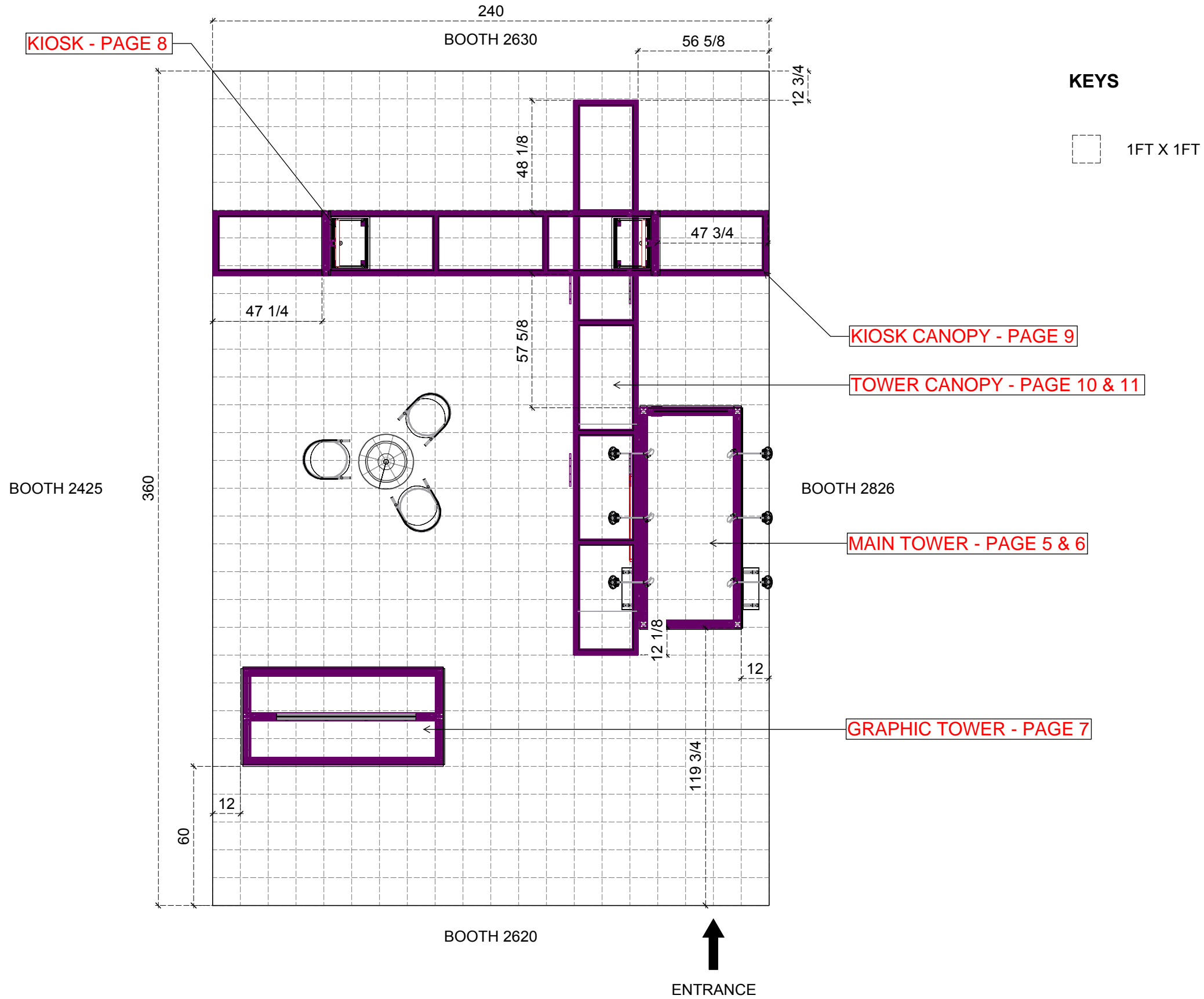

FLOOR PLAN



KEEP 3D LETTERS ATTACHED TO PANELS

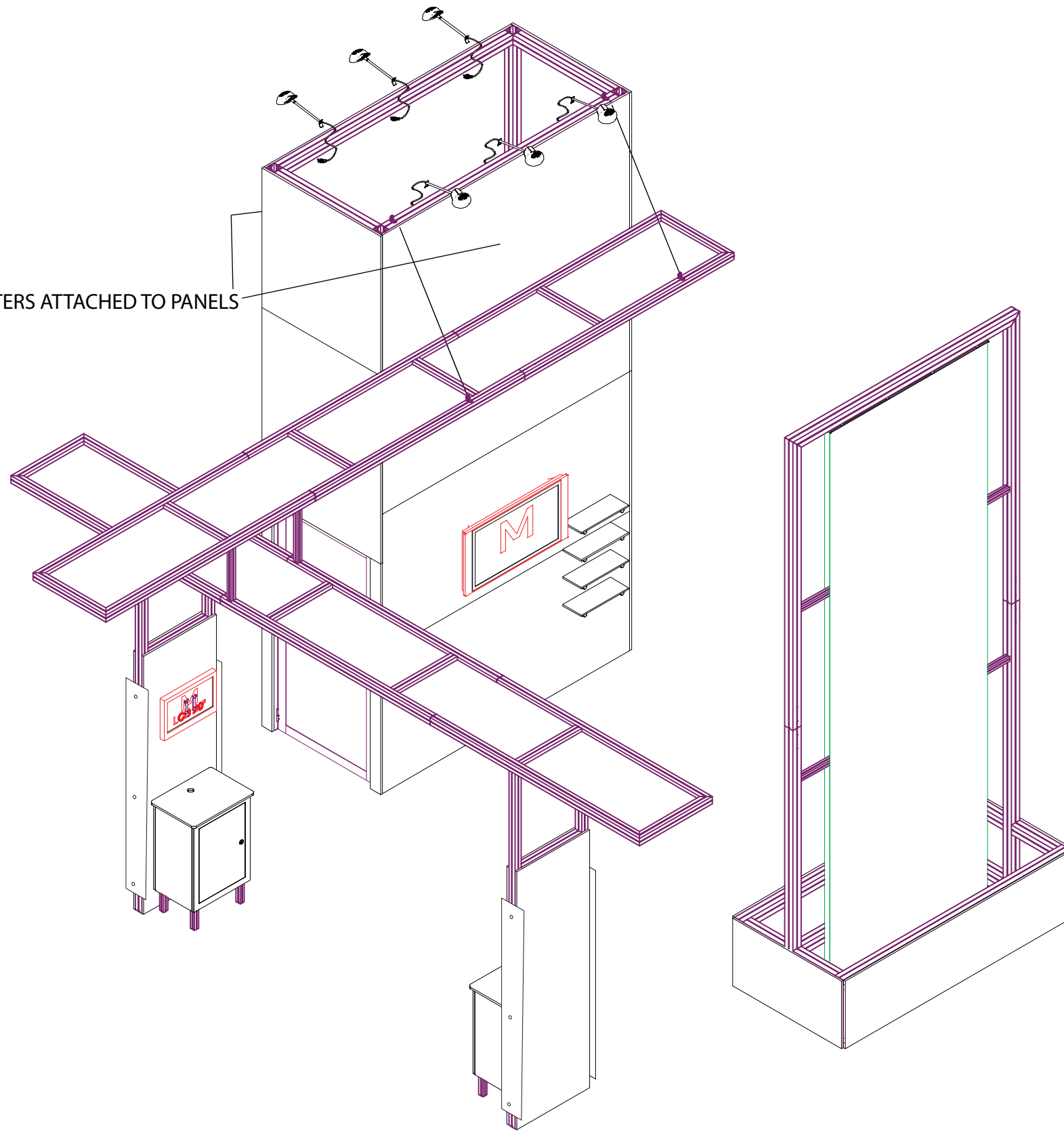

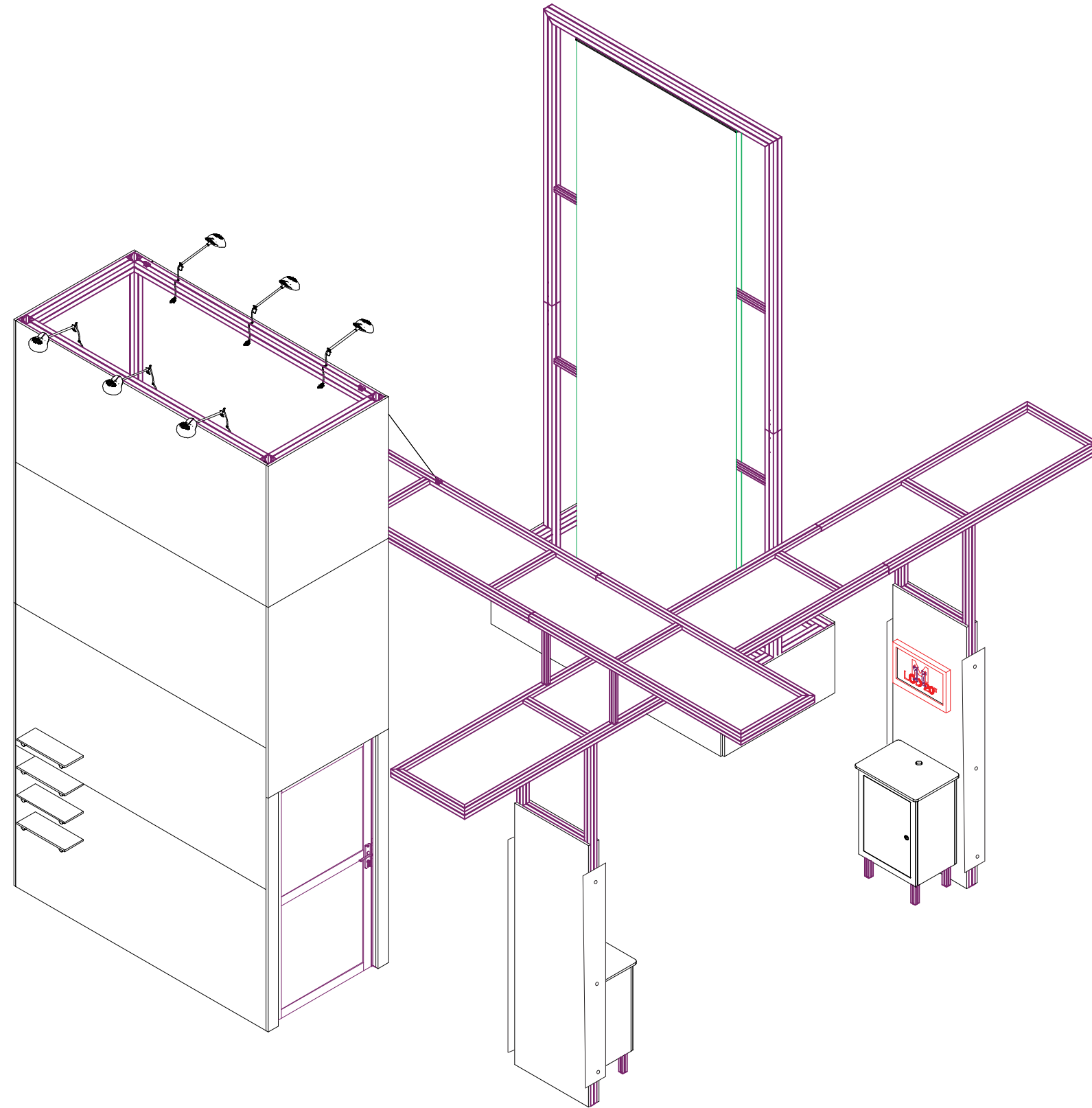
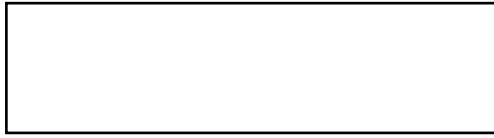

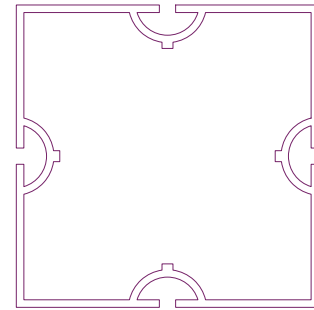
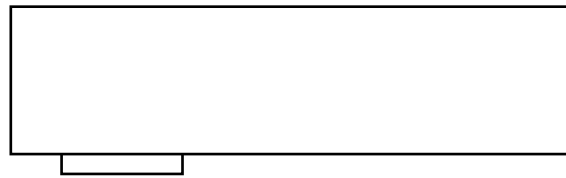

M1020

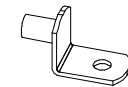

SHELF PIN

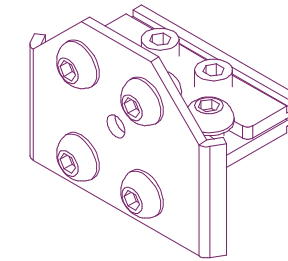

E264.37

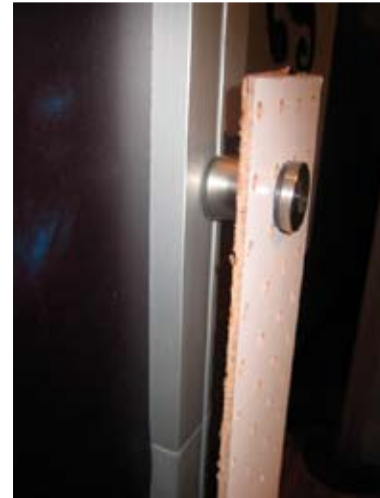

Barrel and cap for pegboard

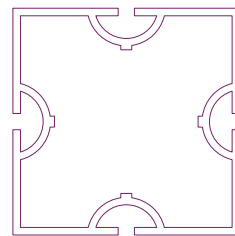

M1010

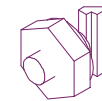

**M1475
HAMMER
HEAD SCREW**

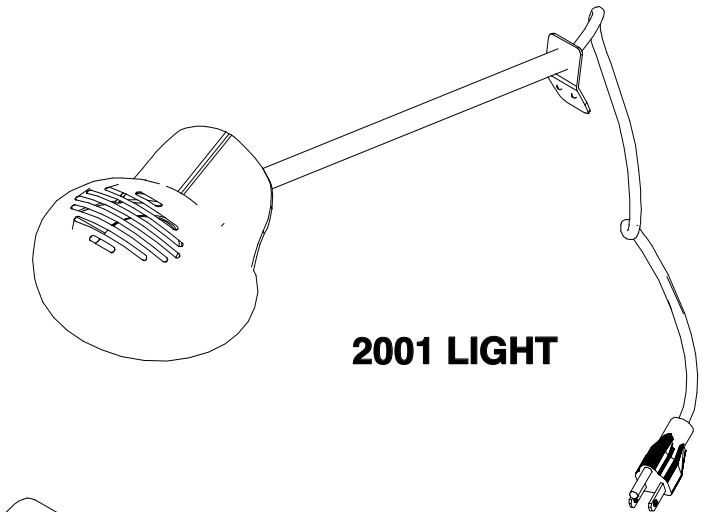

2001 LIGHT

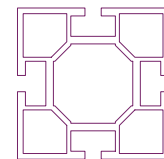

M1000

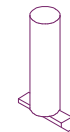

E203.38

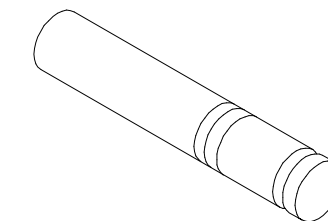

Shelf Standoff Brackets



Z4400

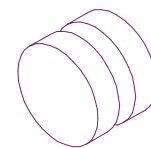

M1391

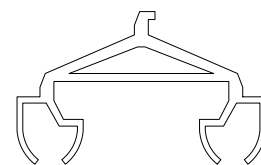

M1360 (fabric banners)

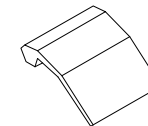

Clips for M1360

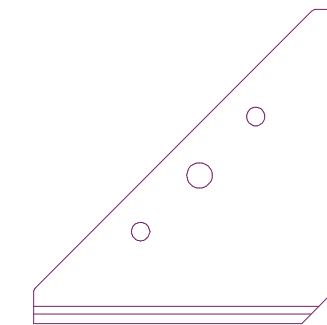

**M1129.37
90 Degree Angle Brace**

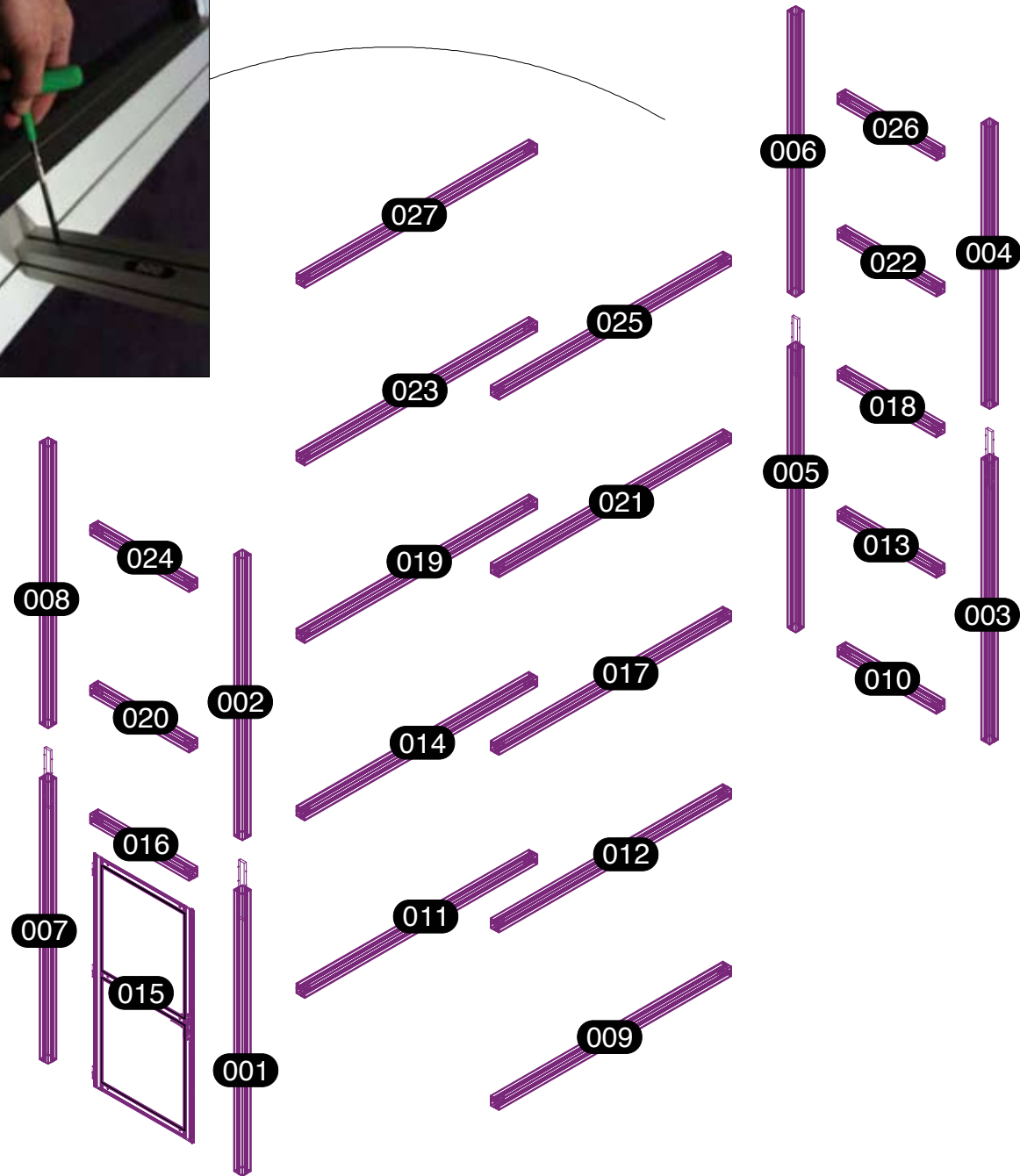

NEVER REMOVE ANY FIXED HARDWARE THAT COMES PRE-ASSEMBLED ON THE EXTRUSIONS.

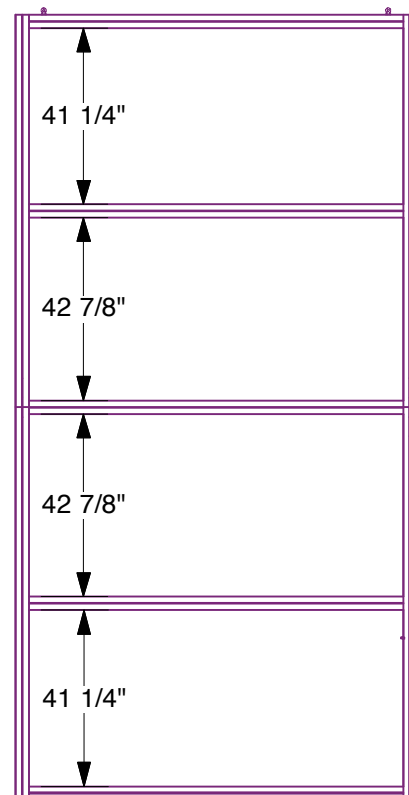
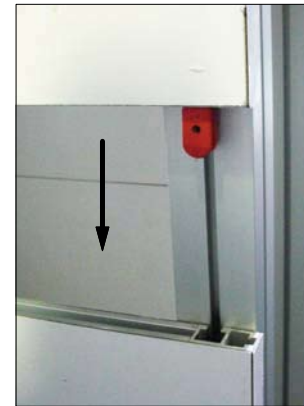

VERY IMPORTANT: PANEL # 031 SHOULD NOT BE INSTALLED UNTIL AFTER EXTRUSIONS 128 AND 130 ARE ATTACHED WITH HAMMER HEADS TO PANEL 030. ONCE THEY ARE ATTACHED AND CONNECTED TO THE KIOSK CANOPY AND THE CABLES ARE ATTACHED TO THE TOWER, PANEL 031 MAY BE APPLIED TO THE TOWER.

Step 1
place these panels first

Step 4
Place panels 036-037 then panel 031

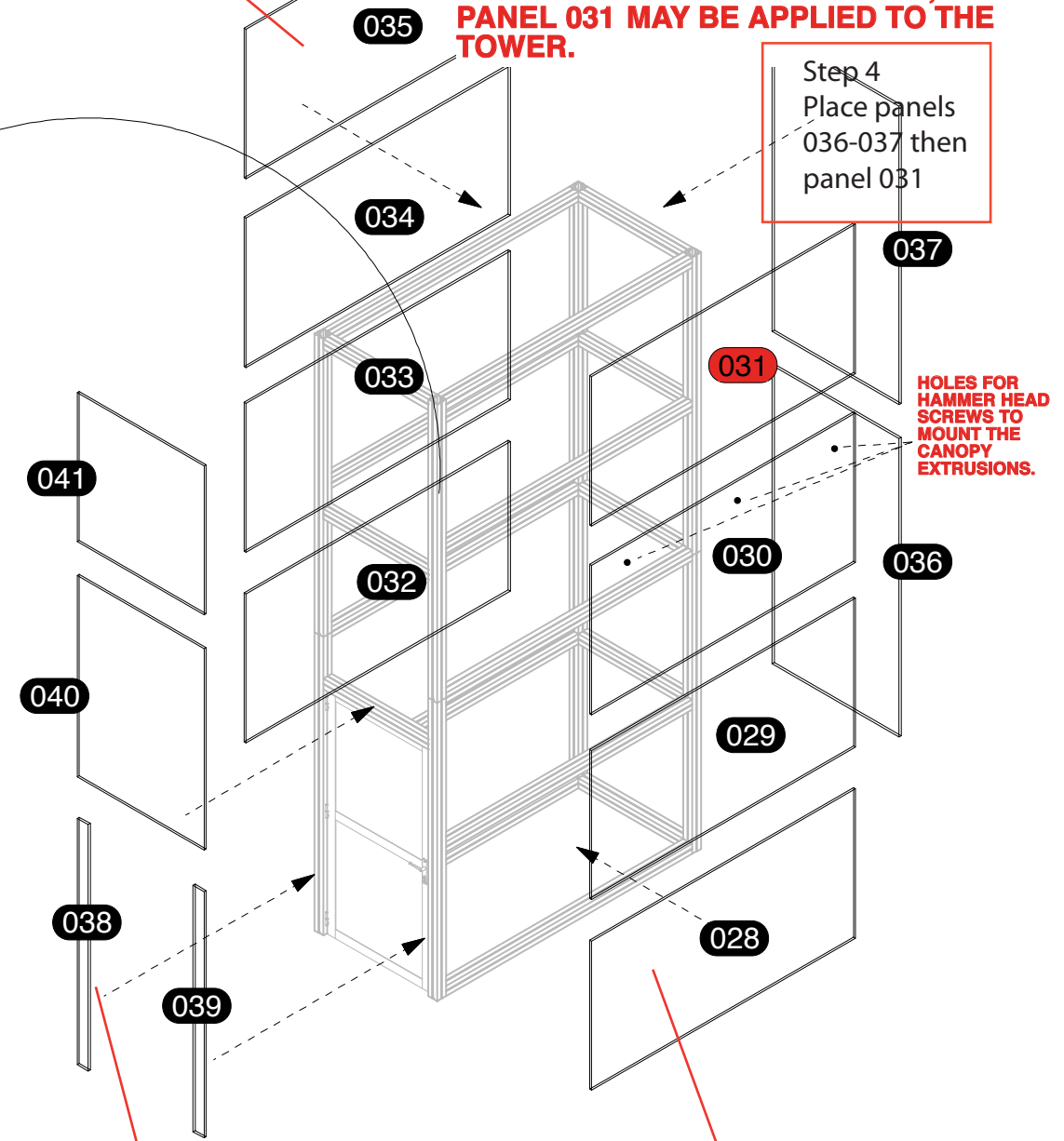

Step 3
Place panels and door

Step 2
Place panels 028-029-030

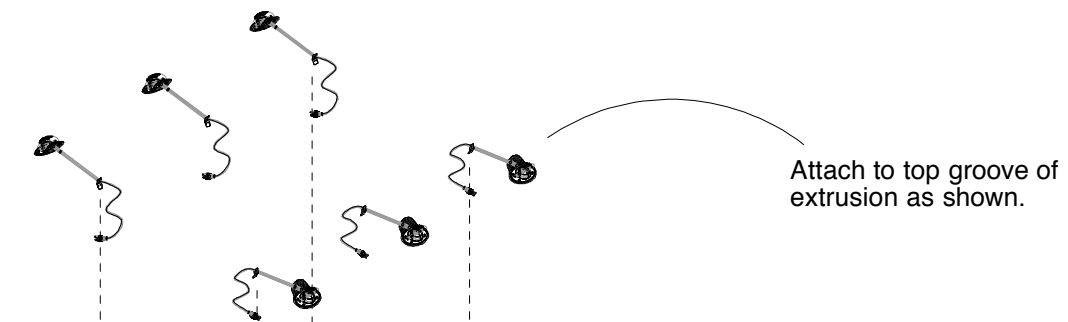

**IMPORTANT NOTICE:
 ADDING ALL ITEMS ON THIS
 PAGE TO THE TOWER SHOULD
 ONLY BE DONE AFTER THE 2
 CANOPIES ARE IN PLACE.
 PLEASE SEE PAGES 5, 9 AND 10.**



Attach shelf standoff brackets to panel as shown.

- 048
- 049
- 050
- 051

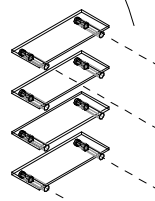

**HOLES FOR
 HAMMER HEAD
 SCREWS TO
 MOUNT THE
 CANOPY
 EXTRUSIONS.**

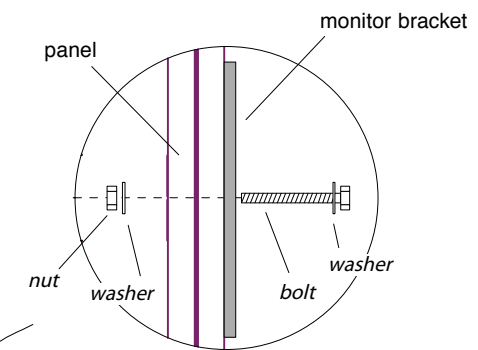

Attach monitor bracket to panel as shown.

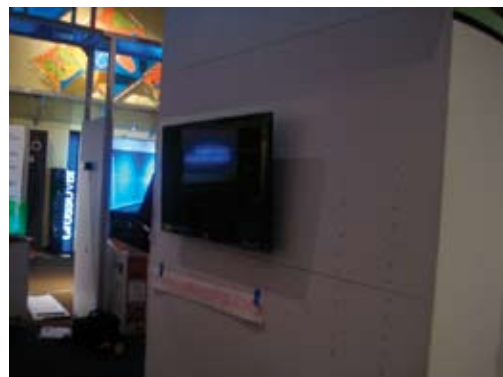

Monitor Mounted outside



Plate inside of closet

042

043

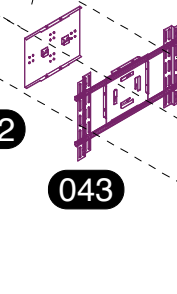

044

045

046

047

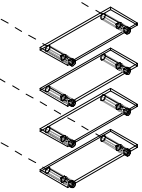

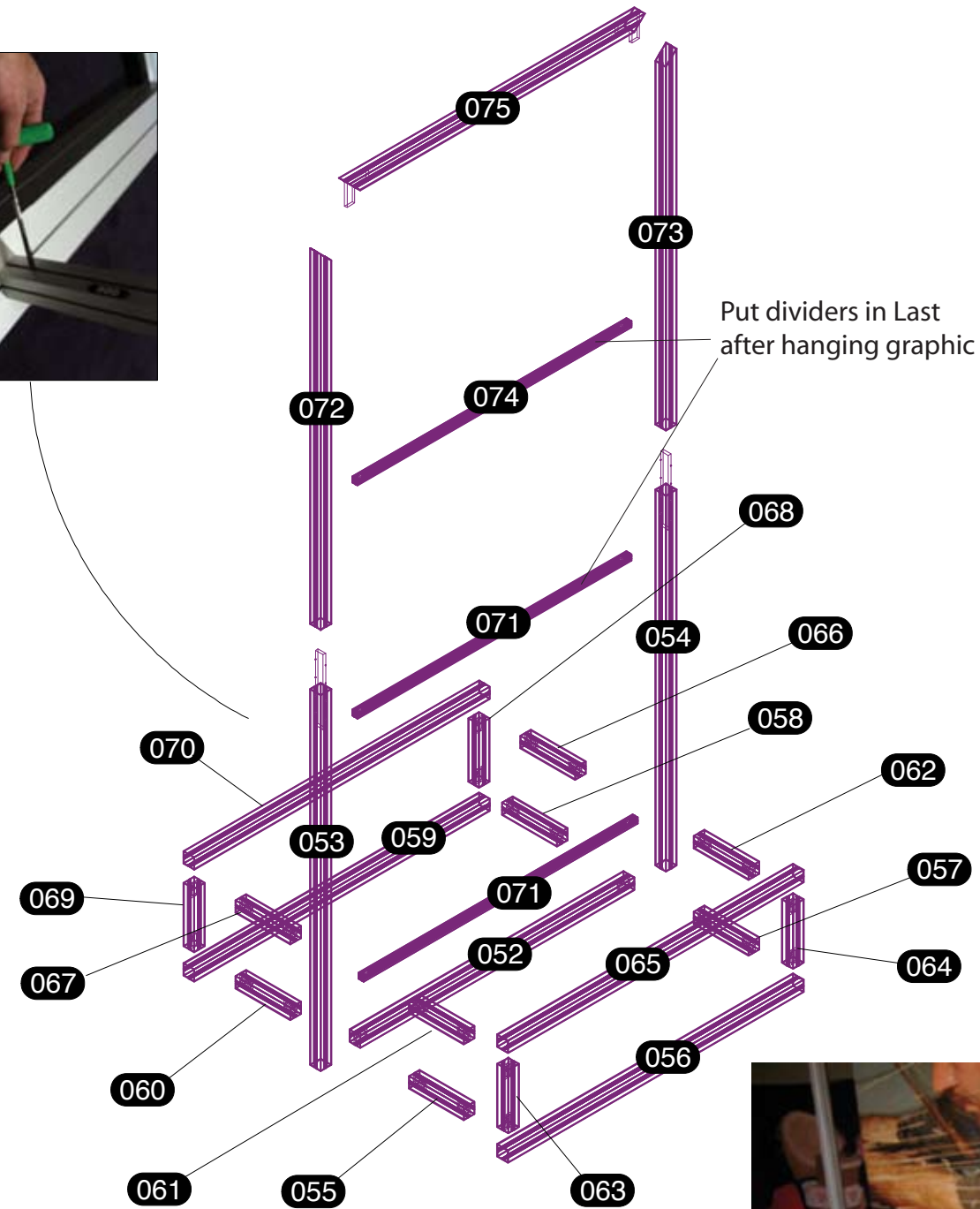
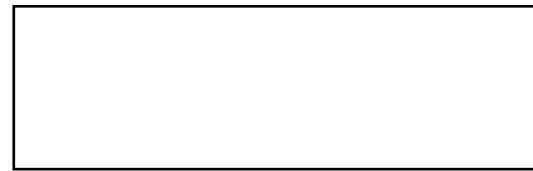
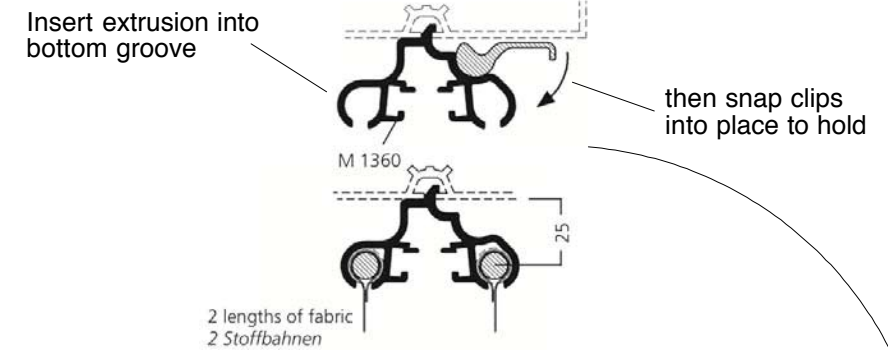

NEVER REMOVE ANY FIXED HARDWARE THAT COMES PRE-ASSEMBLED ON THE EXTRUSIONS.

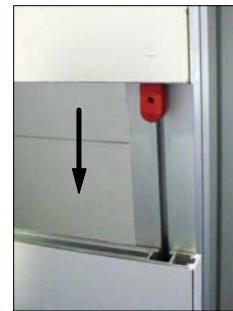

Use low profile velcro in the toolbox to affix plexi to top.

42" and 24" tube lights jump to each other Power inside of structure

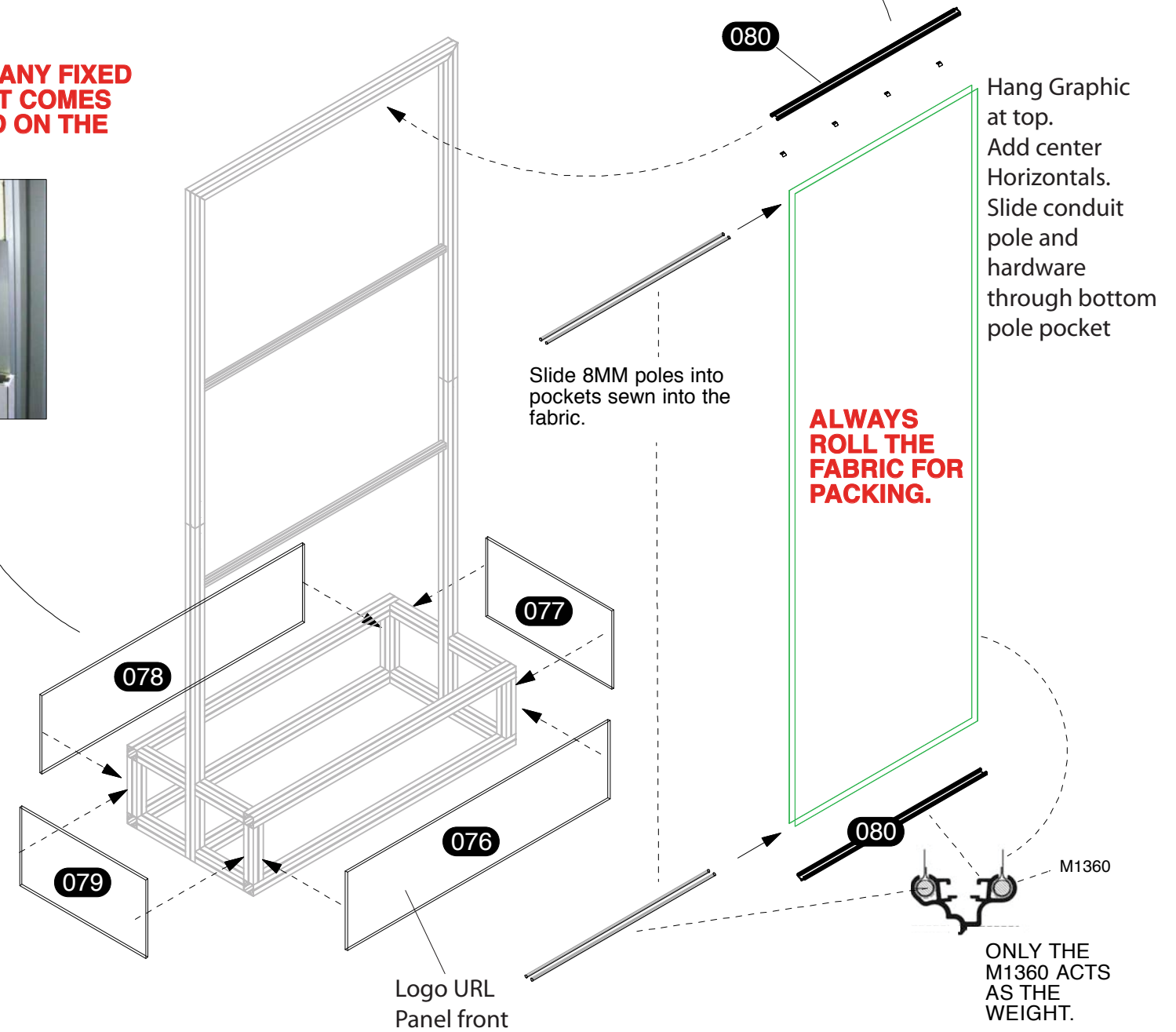

**NEVER REMOVE ANY FIXED
HARDWARE THAT COMES
PRE-ASSEMBLED ON THE
EXTRUSIONS.**

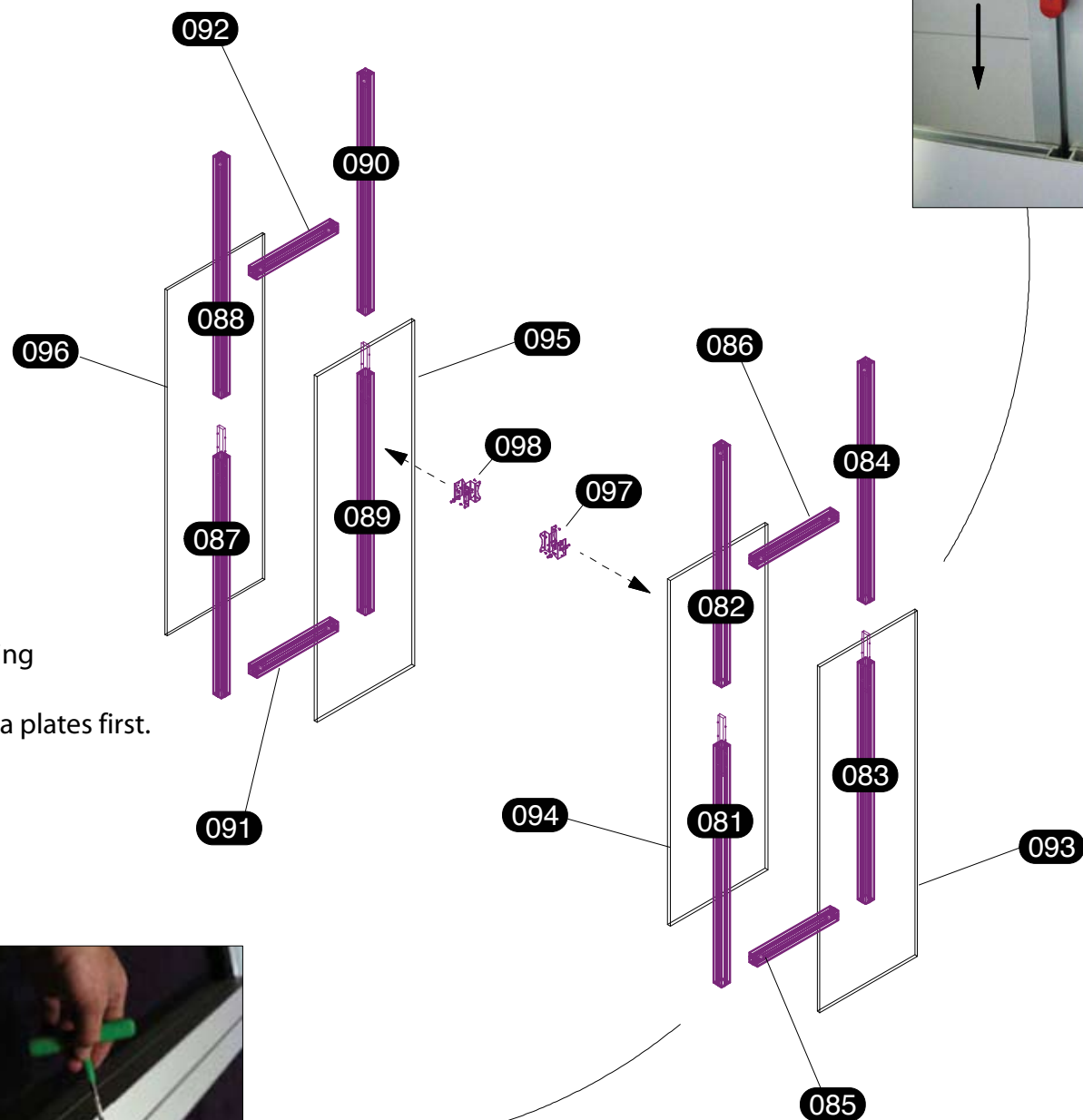
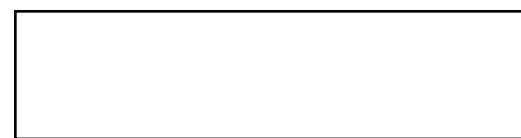

Before Installing
094 and 095
mount plasma plates first.

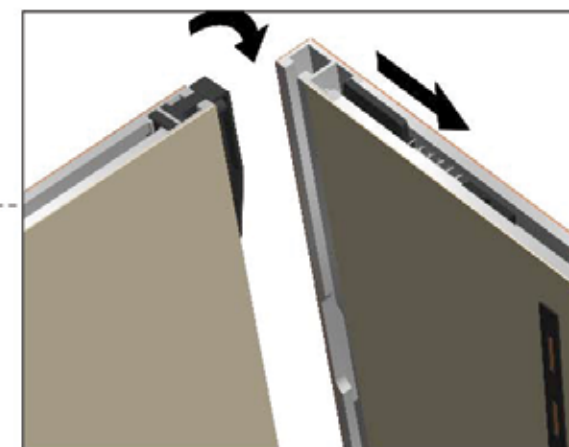
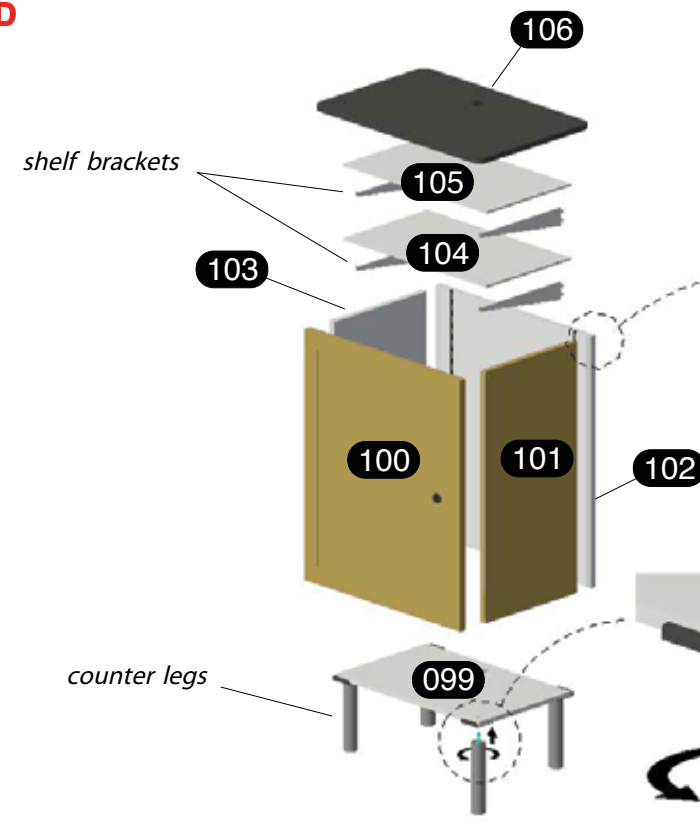

Screw legs to underside of base.
Assemble panels as shown, by pulling
back lock tab, sliding side panel into
front panel, and releasing lock to
engage. Lower assembled panels onto
base, resting on black brackets. Attach
shelf brackets and insert shelves.
Lower counter top onto panels.

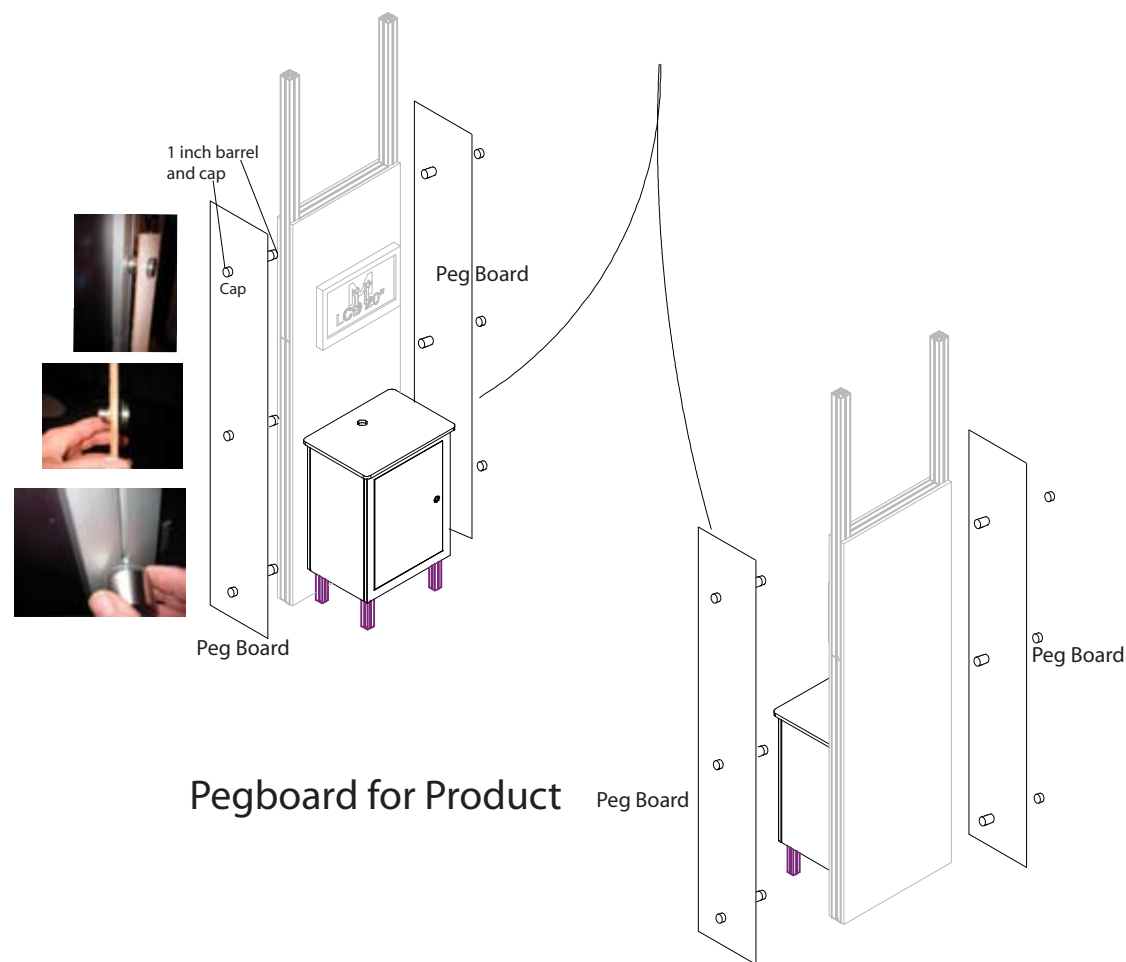

Pegboard for Product



**VERY IMPORTANT:
MAKE SURE THAT THE
KIOSKS AND CEILING ARE
POSITIONED SQUARE TO
THE TOWER AND IN THE
CORRECT LOACTIONS ON
THE FLOOR AS
DIMENSIONED ON PAGE 1.**

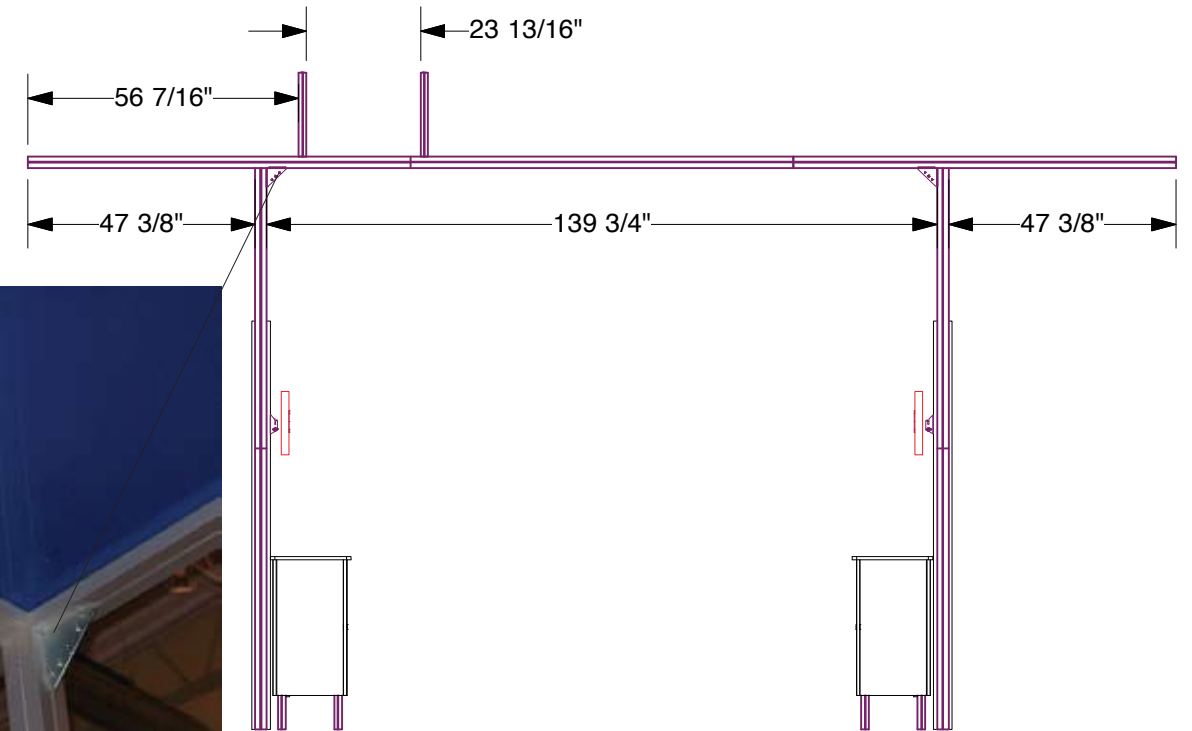
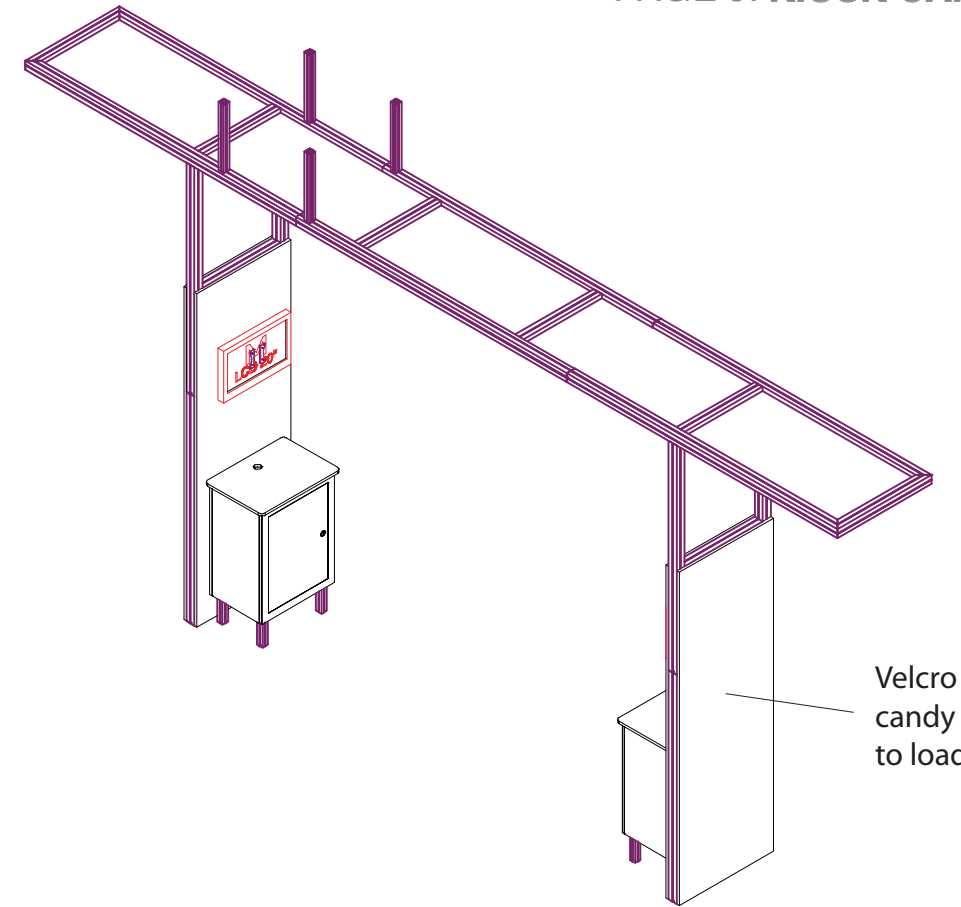
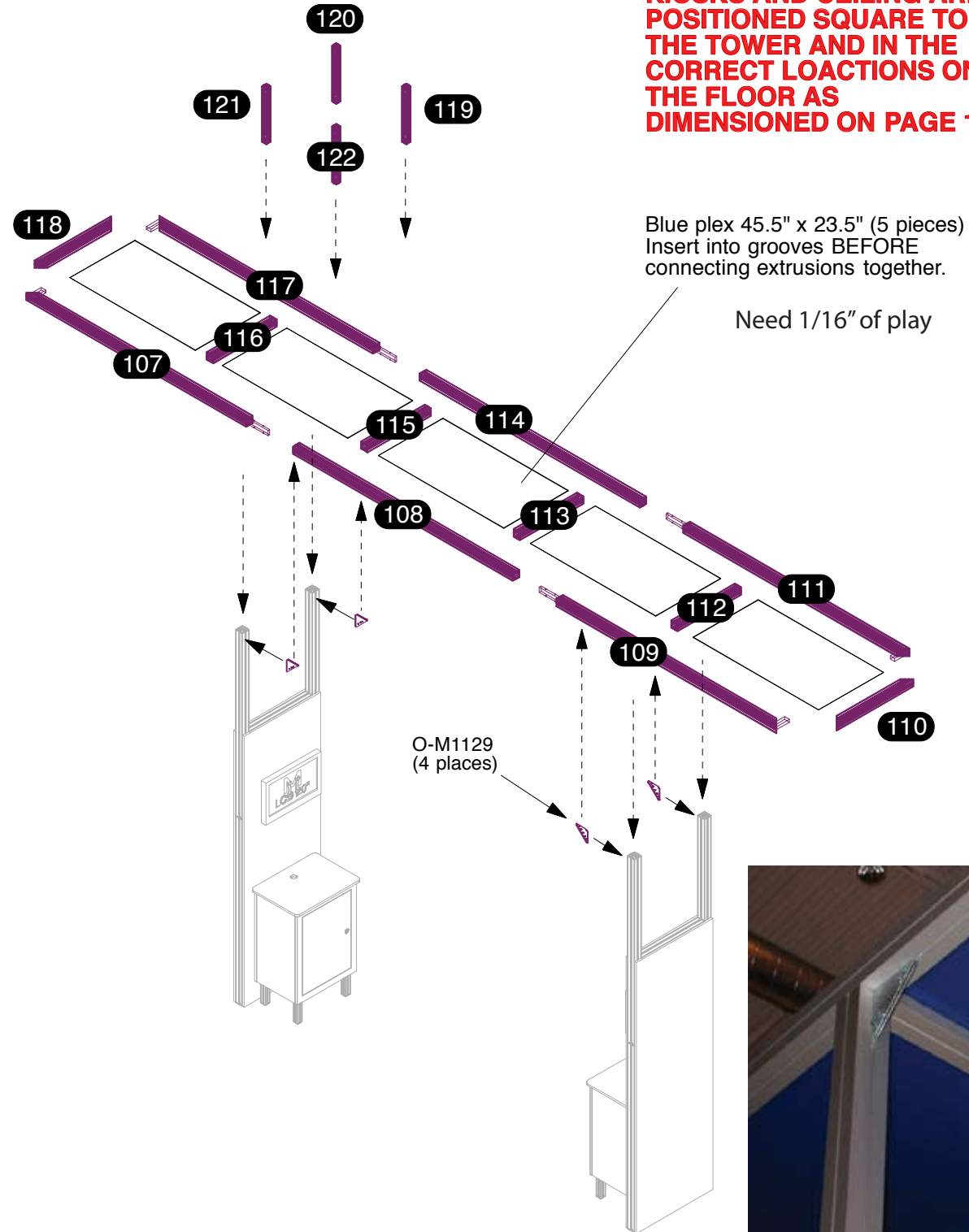

Corner Brackets

**VERY IMPORTANT:
BUILD PARTS 123, 132, 133,
134 WITH THE PLEX AND
ATTACH THEM TO THE KIOSK
CANOPY. DO NOT CONTINUE
WITH THE REST OF THIS
CANOPY UNTIL THE LAST
TOWER PANEL IS IN PLACE
AND THE CABLES ARE
ATTACHED TO THE TOWER.**

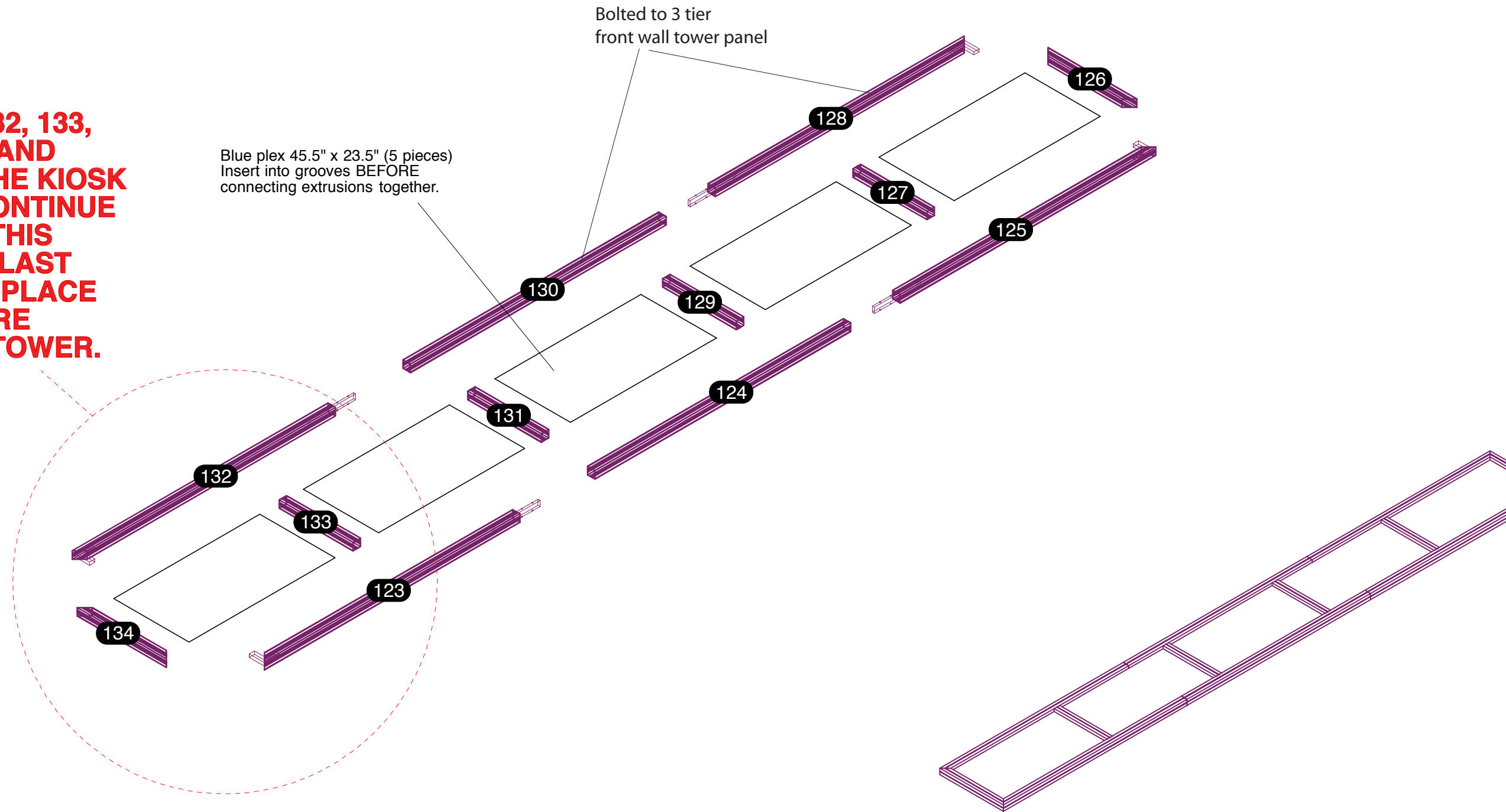



Install assembled canopy as shown...

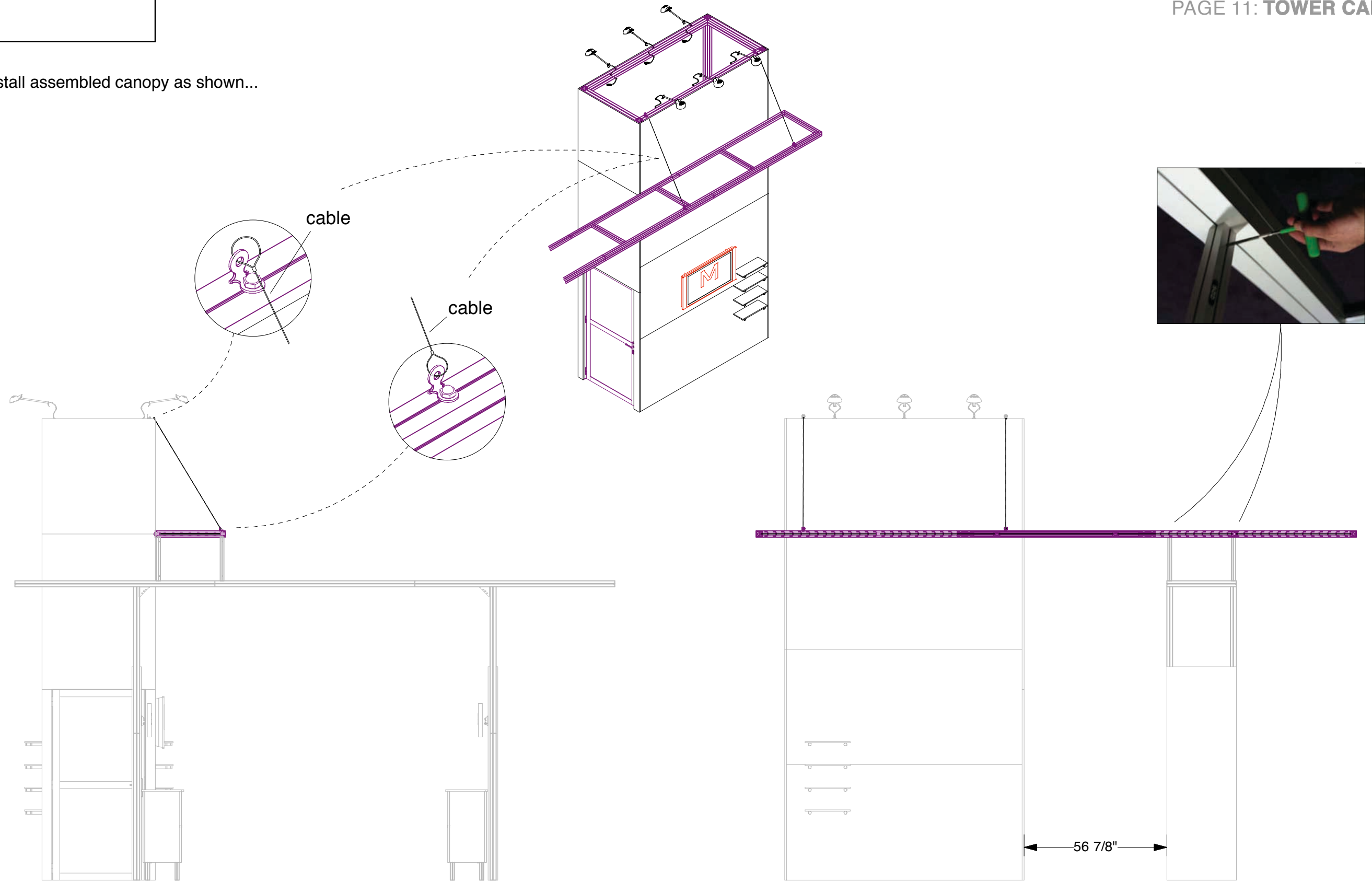



DO NOT DISCARD ANY PACKING MATERIALS. PACK IN THE SAME MANNER AS RECEIVED. ALWAYS PACK TO PROTECT.

FLIGHT CASE #1

ALL EXTRUSIONS GO INTO THIS CASE.

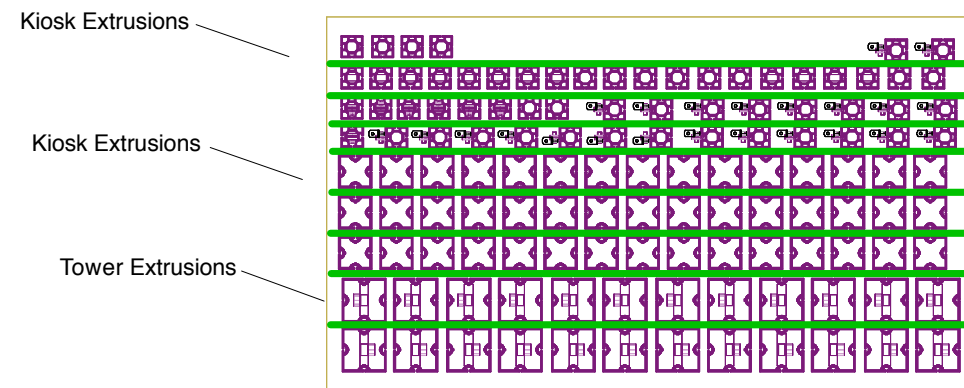

Wood and Felt Extrusion Dividers

FLIGHT CASE #2

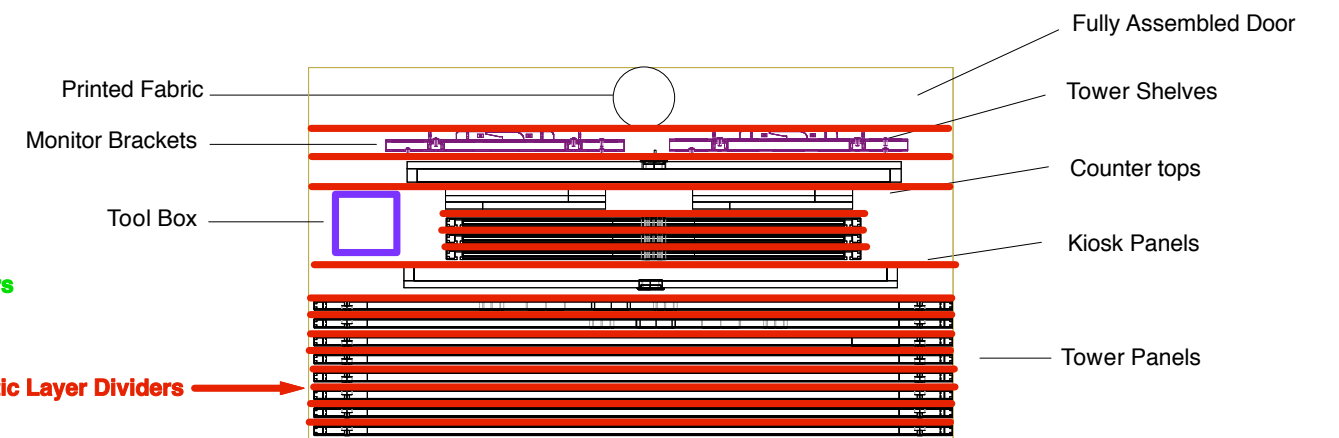

White Sheet Plastic Layer Dividers

MAIN TOWER

001	M1020.01-92in w/SPLICE
002	M1020.01-92in
003	M1020.01-92in w/SPLICE
004	M1020.01-92in
005	M1020.01-92in w/SPLICE
006	M1020.01-92in
007	M1020.01-92in w/SPLICE
008	M1020.01-92in
009	M1020.01-87.69in
010	M1020.01-37.41in
011	M1020.01-87.69in
012	M1020.01-87.69in
013	M1020.01-37.41in
014	M1020.01-87.69in
015	Full size door assembly
016	M1020.01-37.41in
017	M1020.01-87.69in
018	M1020.01-37.41in
019	M1020.01-87.69in
020	M1020.01-37.41in
021	M1020.01-87.69in
022	M1020.01-37.41in
023	M1020.01-87.69in
024	M1020.01-37.41in
025	M1020.01-87.69in
026	M1020.01-37.41in
027	M1020.01-87.69in
028	46"h x 94"w wood fill for shelves
029	46"h x 94"w (WOOD-FILLED FOR MONITOR)
030	46"h x 94"w panel
031	46"h x 94"w panel
032	46"h x 94"w wood fill for shelves
033	46"h x 94"w wood fill for shelves
034	46"h x 94"w panel
035	46"h x 94"w panel
036	92"h x 45.192"w panel
037	92"h x 45.192"w panel
038	76"h x 3.9"w panel
039	76"h x 3.9"w panel
040	62"h x 45.192"w panel
041	46" x 45.192" panel

TOWER ACCESSORIES

042	BT8500 Plasma Screen Interface
043	BTX26 Large Flat Panel Exhibition Bracket
044	Shelf - 1/2" Laminated 18" x 7"
045	Shelf - 1/2" Laminated 18" x 7"
046	Shelf - 1/2" Laminated 18" x 7"
047	Shelf - 1/2" Laminated 18" x 7"
048	Shelf - 1/2" Laminated 18" x 7"
049	Shelf - 1/2" Laminated 18" x 7"
050	Shelf - 1/2" Laminated 18" x 7"
051	Shelf - 1/2" Laminated 18" x 7"

GRAPHIC TOWER

052	M1020.01-80in
053	M1020.01-95in w/SPLICE
054	M1020.01-95in w/SPLICE
055	M1020.01-16in
056	M1020.01-86.3in
057	M1020.01-16in
058	M1020.01-16in
059	M1020.01-86.3in
060	M1020.01-16in
061	M1020.01-16in
062	M1020.01-16in
063	M1020.01-16in
064	M1020.01-16in
065	M1020.01-86.3in
066	M1020.01-16in
067	M1020.01-16in
068	M1020.01-16in
069	M1020.01-16in
070	M1020.01-86.3in
071	M1000.01-80in (2 PCS.)
072	M1020.01-95in.-cut45Rdeg
073	M1020.01-95in.-cut45Rdeg
074	M1000.01-80in
075	M1020.01-86.31in.-cut45deg (2)
076	22.299" x 86.299" panel
077	22.299" x 41.449" panel
078	22.299" x 86.299" panel
079	22.299" x 41.449" panel
080	M1360 Fabric Suspension Extrusion - 60" (QTY. 2)

KIOSKS

081	M1010.01-58.49in w/SPLICE
082	M1010.01-58.49in
083	M1010.01-58.49in w/SPLICE
084	M1010.01-58.49in
085	M1010.01-23in
086	M1010.01-23in
087	M1010.01-58.49in w/SPLICE
088	M1010.01-58.49in
089	M1010.01-58.49in w/SPLICE
090	M1010.01-58.49in
091	M1010.01-23in
092	M1010.01-23in
093	85"h x 27.725"w panel
094	85"h x 27.725"w with monitor mount holes
095	85"h x 27.725"w with monitor mount holes
096	85"h x 27.725"w panel
097	BT7511 LCD Screen Tilt Mount VESA
098	BT7511 LCD Screen Tilt Mount VESA

COUNTERS

099	Counter base
100	Door panel
101	Side panel
102	Rear panel
103	Side panel
104	Inner shelf
105	Inner shelf
106	Counter top

KIOSK CANOPY

107	M1010.01-79.72in w/SPLICE (45deg end)
108	M1010.01-79.72in w/SPLICE
109	M1010.01-79.72in (45deg end)
110	M1010.01-27.75in.-cut45Rdeg (2)
111	M1010.01-79.72in (45deg end)
112	M1010.01-23in
113	M1010.01-23in
114	M1010.01-79.72in w/SPLICE
115	M1010.01-23in
116	M1010.01-23in
117	M1010.01-79.72in w/SPLICE (45deg end)
118	M1010.01-27.75in.-cut45Rdeg (2)
119	M1000.01-17.5in
120	M1000.01-17.5in
121	M1000.01-17.5in
122	M1000.01-17.5in

TOWER CANOPY

123	M1010.01-79.72in w/SPLICE (45deg end)
124	M1010.01-79.72in
125	M1010.01-79.72in w/SPLICE (45deg end)
126	M1010.01-27.75in.-cut45Rdeg
127	M1010.01-23in
128	M1010.01-79.72in w/SPLICE (45deg end)
129	M1010.01-23in
130	M1010.01-79.72in
131	M1010.01-23in
132	M1010.01-79.72in w/SPLICE (45deg end)
133	M1010.01-23in
134	M1010.01-27.75in.-cut45Rdeg