

| BILL OF MATERIALS | | | |
|-------------------|-------------|-----------------------|------|
| ITEM NO. | PART NUMBER | DESCRIPTION | QTY. |
| 1 | 73747-05-01 | 120"W X 96"H ES FRAME | 1 |
| 2 | HD IL 07 | SPLICE LOCK | 2 |
| 3 | HD CL 06 | CORNER LOCK | 4 |
| 4 | HD SL 01 | STRAIGHT LOCK | 14 |

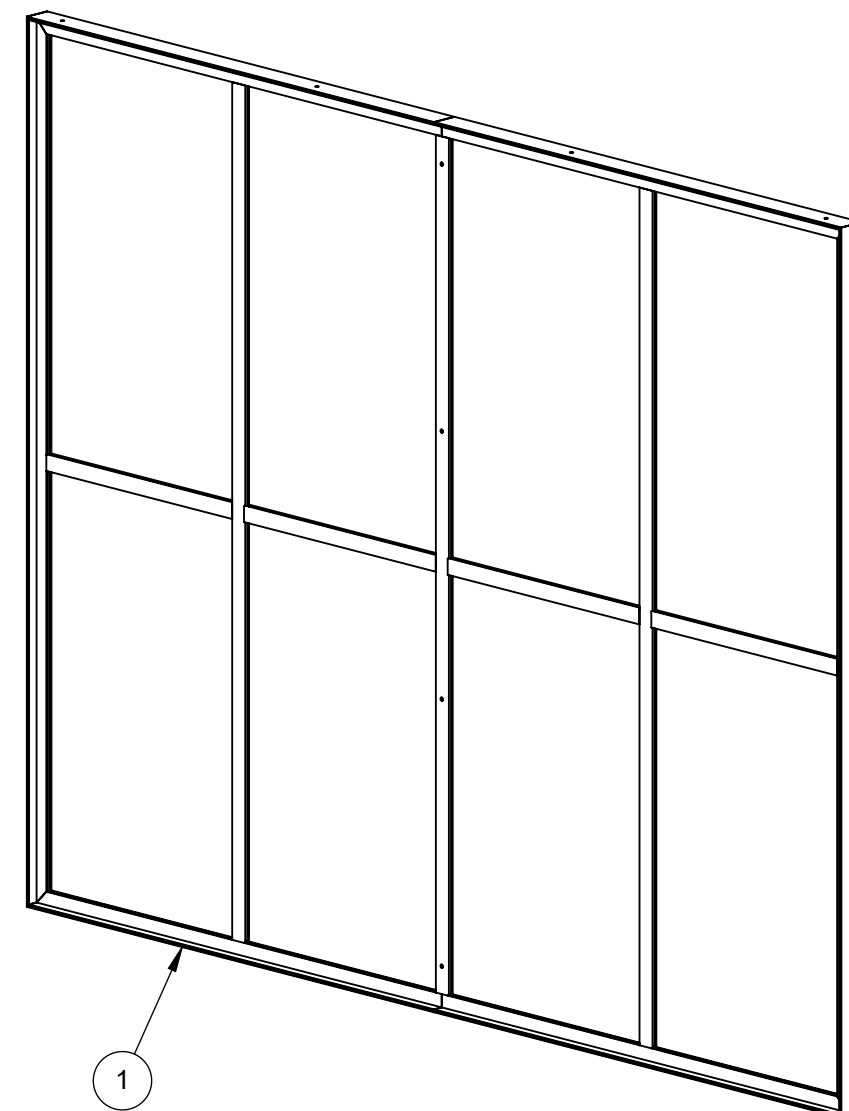
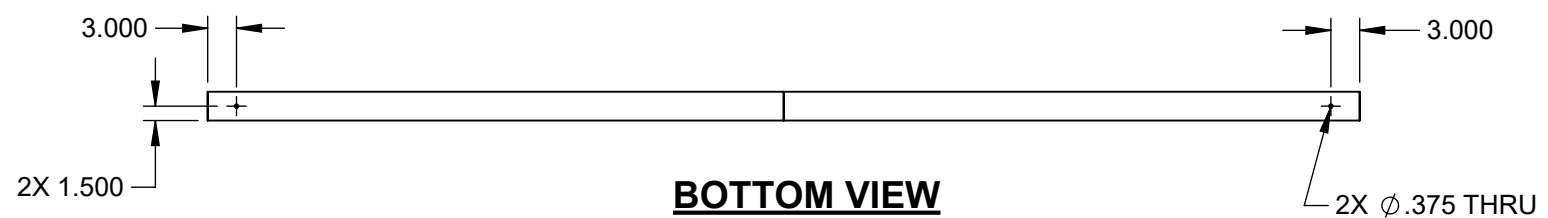
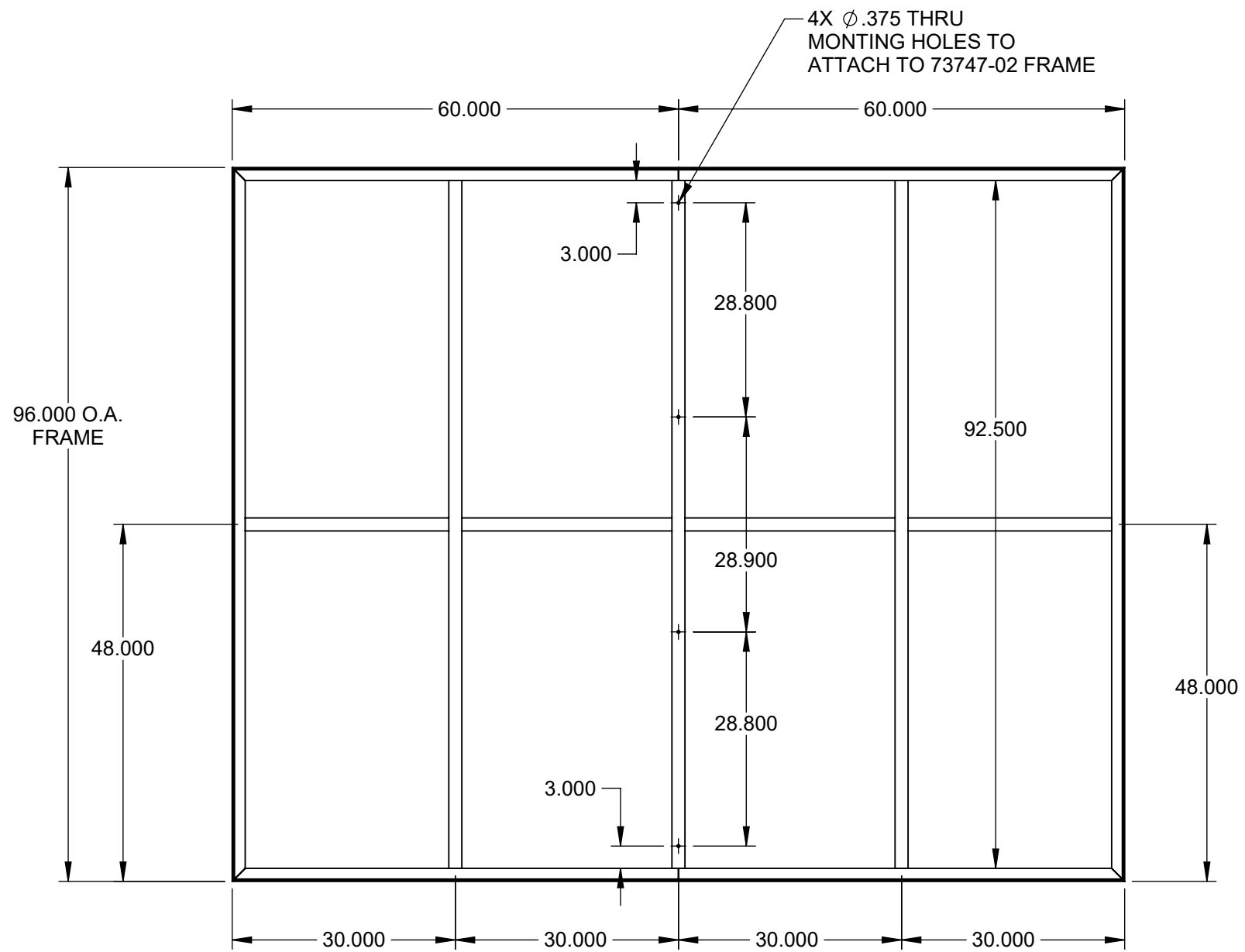
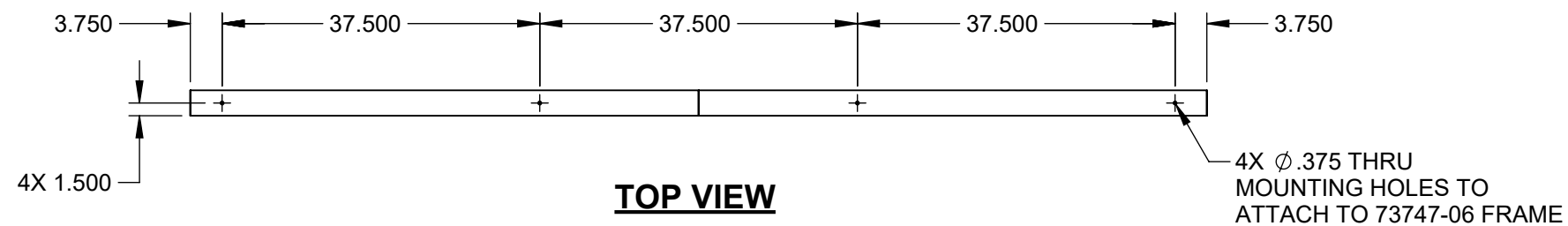

ISOMETRIC VIEW

SNAP TUBE CUT-LIST α

| ITEM NO. | PART NUMBER | DESCRIPTION | QTY. | LENGTH |
|----------|---------------|----------------------------|------|--------|
| 1 | 73747-05-01-1 | FP 2G 02 (FABRIC PROFILE) | 2 | 96 |
| 2 | 73747-05-01-2 | FP 2G 02 (FABRIC PROFILE) | 1 | 60 |
| 3 | 73747-05-01-3 | FP 2G 02 (FABRIC PROFILE) | 1 | 60 |
| 4 | 73747-05-01-4 | SP 2L 02 (SUPPORT PROFILE) | 2 | 92.5 |
| 5 | 73747-05-01-5 | SP 2L 02 (SUPPORT PROFILE) | 2 | 27.375 |
| 6 | 73747-05-01-6 | SP 2L 02 (SUPPORT PROFILE) | 2 | 28.25 |
| 7 | 73747-05-01-7 | FP 2G 02 (FABRIC PROFILE) | 1 | 60 |
| 8 | 73747-05-01-8 | FP 2G 02 (FABRIC PROFILE) | 1 | 60 |
| 9 | 73747-05-01-9 | SP 2L 02 (SUPPORT PROFILE) | 1 | 92.5 |

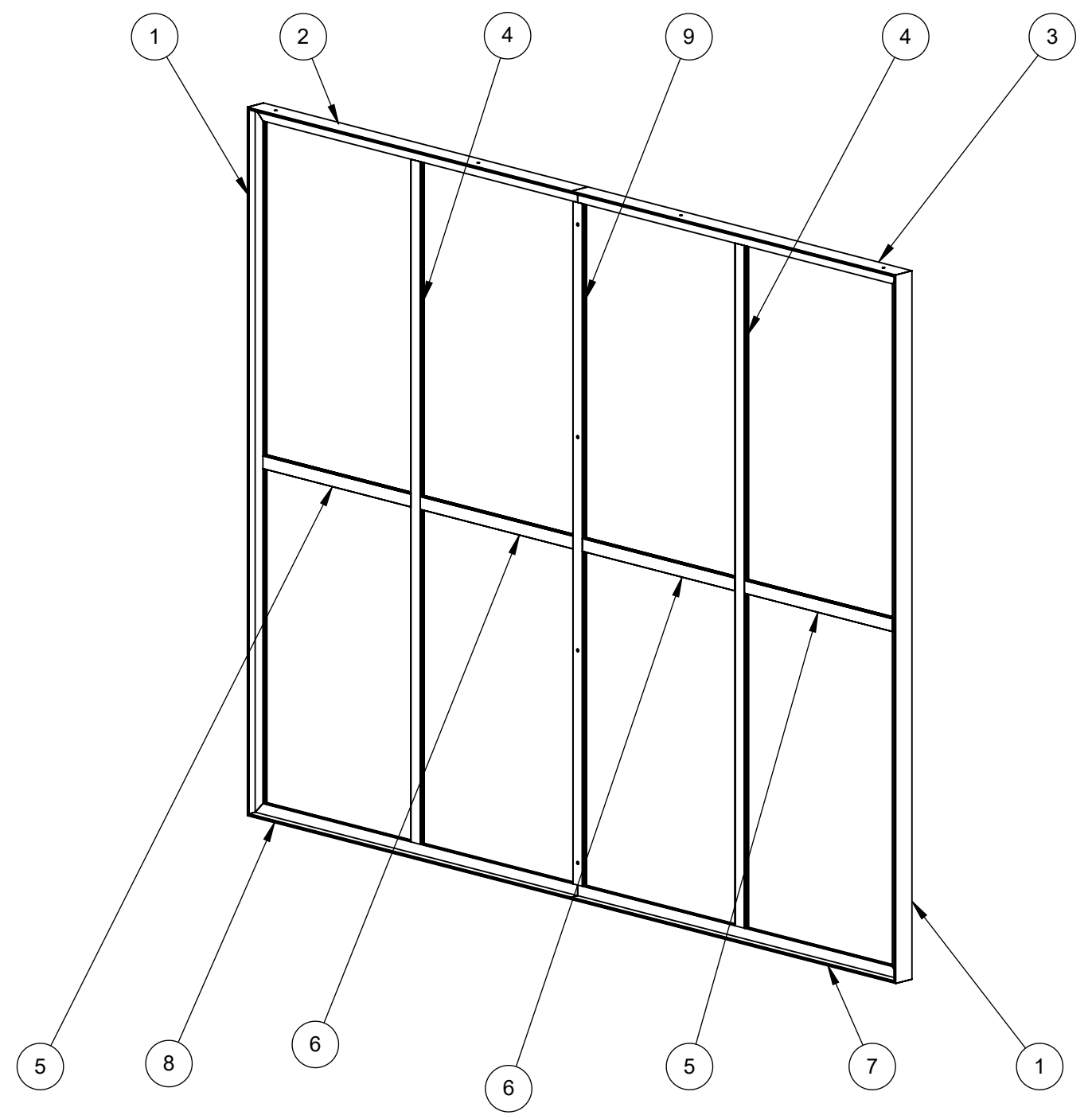

BILL OF MATERIALS

| ITEM NO. | PART NUMBER | DESCRIPTION | QTY. |
|----------|-------------|-----------------------|------|
| 1 | 73747-05-01 | 120"W X 96"H ES FRAME | 1 |
| 2 | HD IL 07 | SPLICE LOCK | 2 |
| 3 | HD CL 06 | CORNER LOCK | 4 |
| 4 | HD SL 01 | STRAIGHT LOCK | 14 |

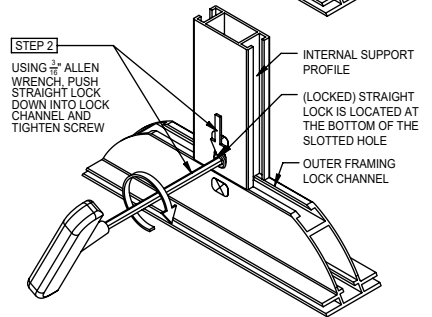
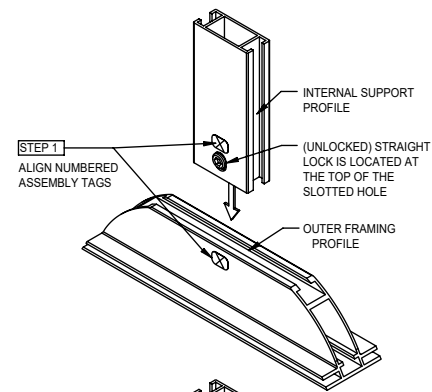

STRAIGHT LOCK CONNECTION
SCALE: FULL

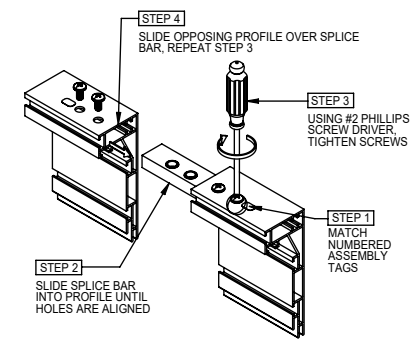

POSITIVE SPLICE LOCK CONNECTION
SCALE: FULL

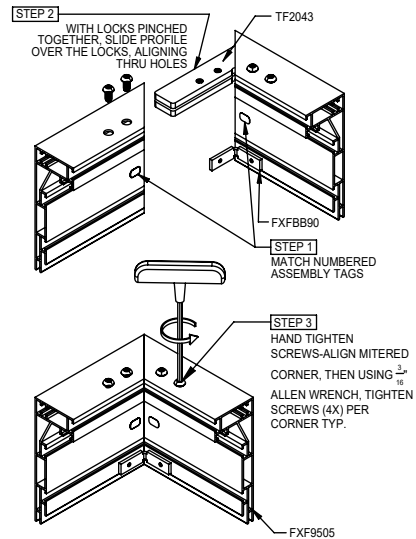

COMPRESSION LOCK CONNECTION
SCALE: FULL

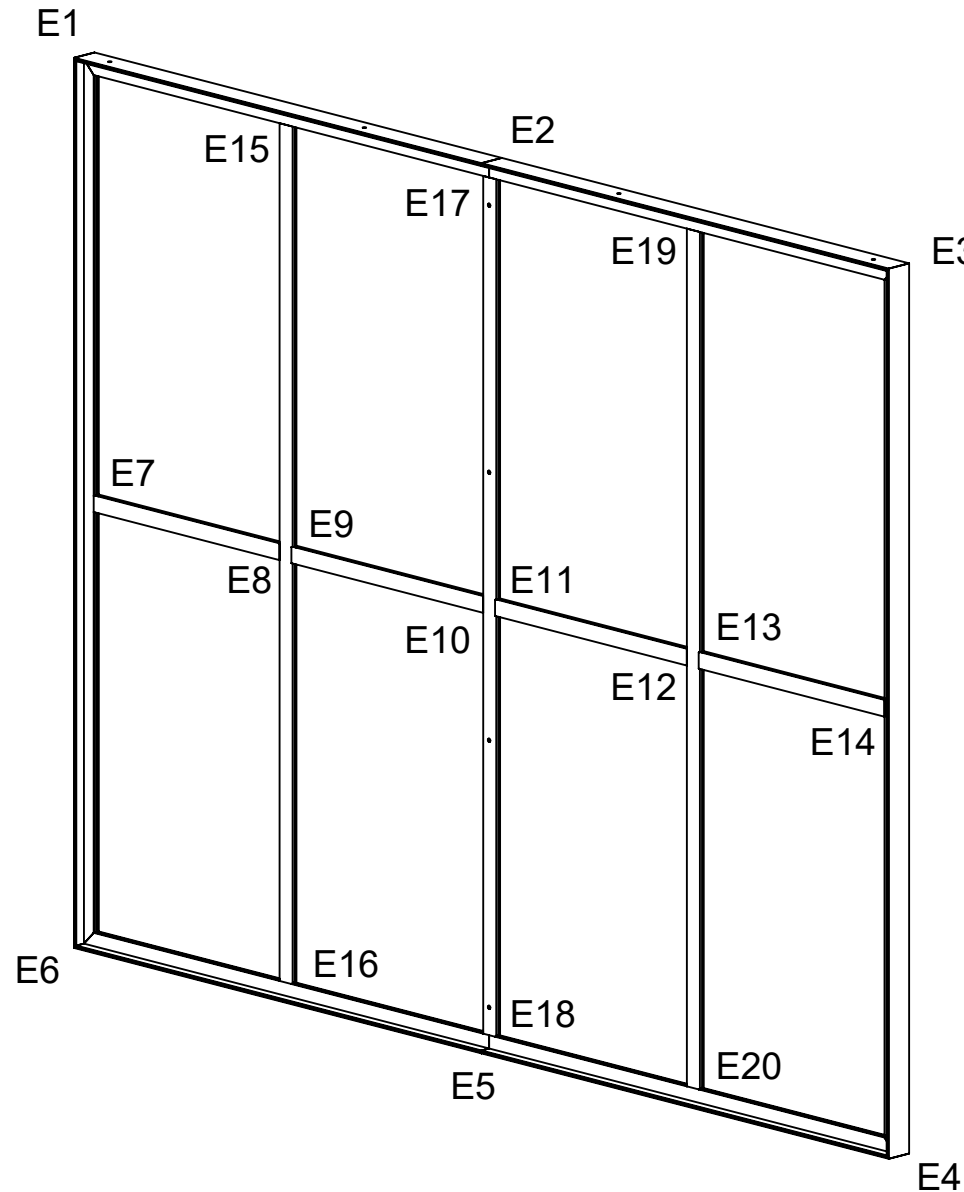

ASSEMBLY ISOMETRIC

X MATCH JOINT TAG WITH NUMBERED DECALS ON FRAME

